

1 2 3 4 5 6 7 8 9

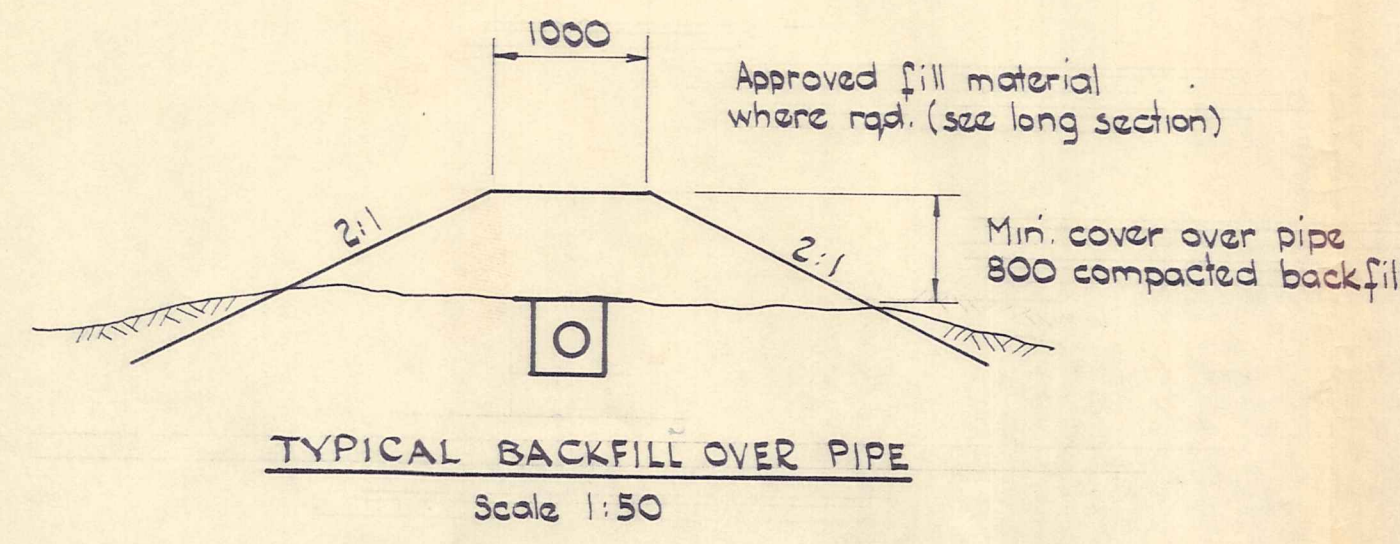

- LEGEND**
- Traverse pegs and manhole positions
 - Manholes not on traverse
 - Sewer line not along traverse
 - Stormwater channel-existing
 - Existing Boundaries

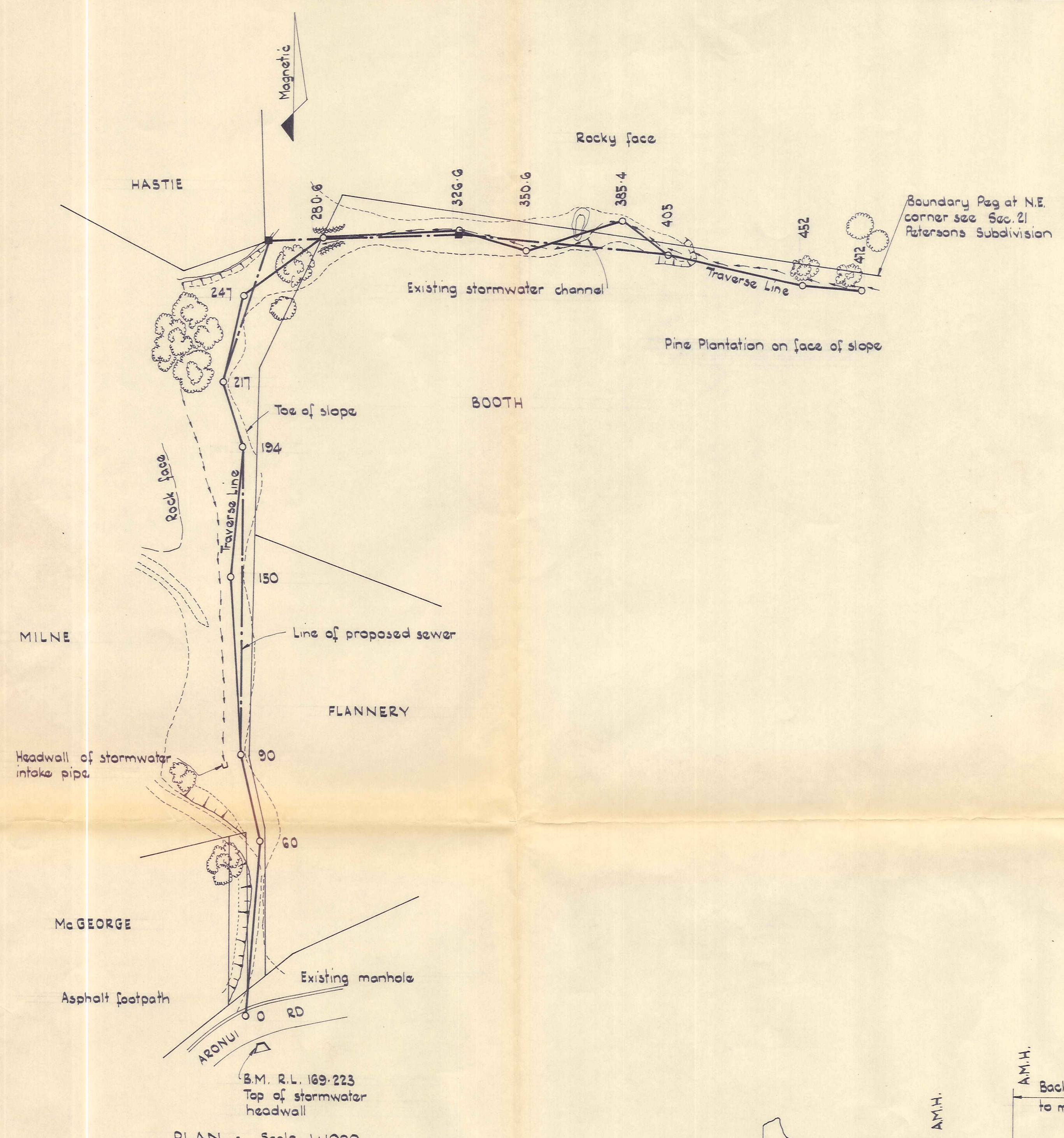
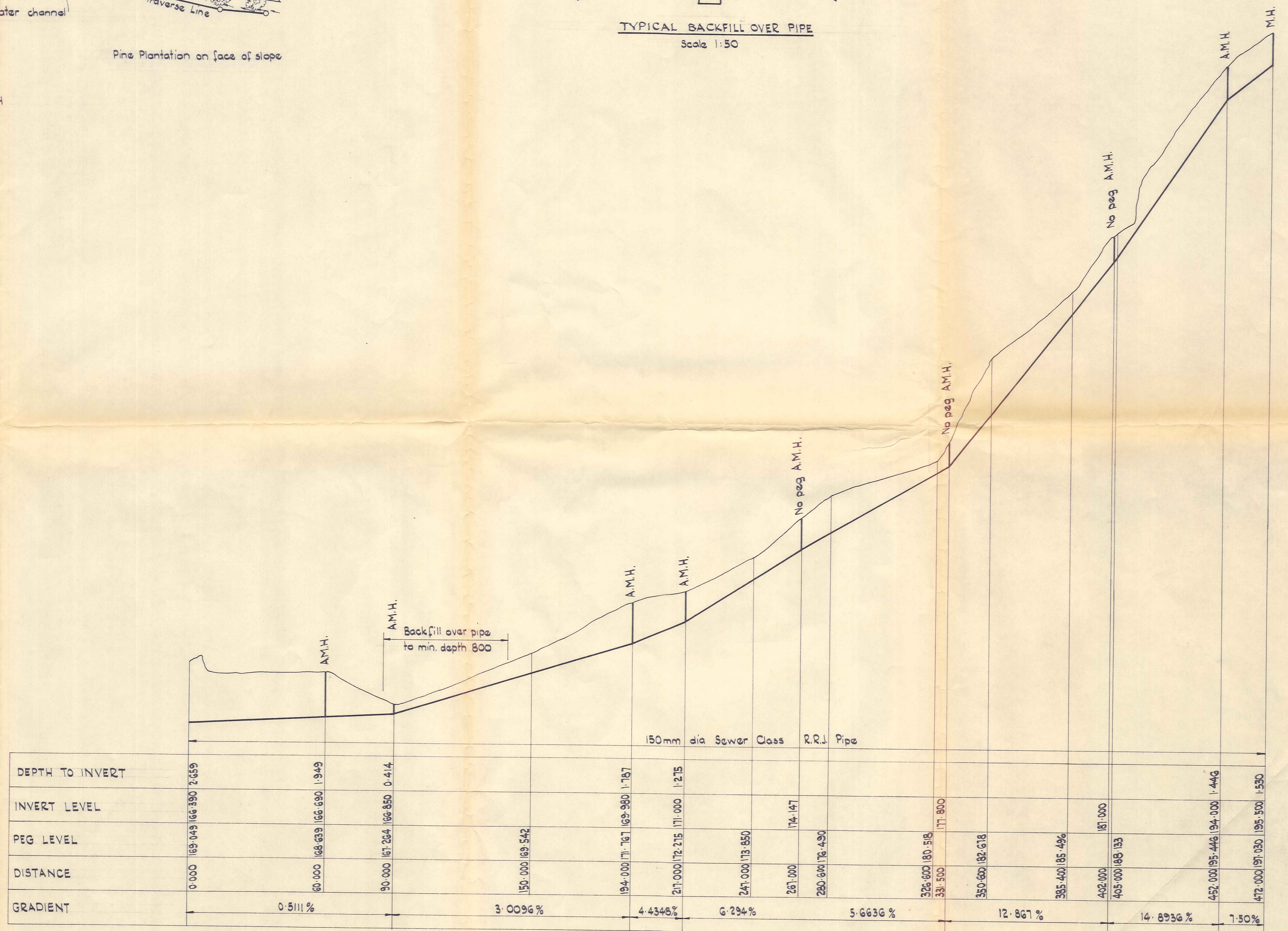

DUFFILL WATTS & KING LTD
 CONSULTING CIVIL & STRUCTURAL ENGINEERS
 Dunedin P.O. Box 5289 Ph. 77-133 Invercargill P.O. Box 576 Ph. 83049
 Balclutha P.O. Box 220 Phone 1425
 Cromwell P.O. Box 82 Phone 96

ALEXANDRA BOROUGH COUNCIL

**TRUNK SANITARY SEWER
 PETERSONS SUBDIVISION - BRIDGE HILL**

DATUM
Assumed

ORIGIN
As Shown



AMENDMENTS			
NO.	BY	DATE	Appvd.

NAME	DATE
Surveyed G.R. Gillespie	Oct '76
Drawn G.R. Gillespie	Oct '76
Calculations " "	" "
Traced A.H. Mgeorge	March '77
Checked " "	" "
Approved " "	21/3/77

JOB NO. **8488**

Sheet No. **1**

of **1** sheets

File 2/16/8 L.B. 300 F.B.

2 3 4 5 6 7 8 9