

DESCRIPTION

All that area of land containing 380 hectares more or less being part public road, part Crown Land Water Race, part Freehold land and part leasehold Crown Land under deferred payment Licence and renewable lease, situated in Blocks V1 and V11. Lauder Survey District, Otago Land District, Vicent County Council, with boundaries more particularly described as follows:

Commencing at a point being the intersection between the Western boundary of Duggan Road and the Southern boundary of Wallington Road and proceeding in a Northerly direction crossing Wallington Road and following the Western boundary of Duggan Road for a distance of 1450 metres approximately to the South Eastern boundary of Mining Privilege P.L. 31-1236, thence in a North Easterly direction on bearing 51 degrees by right line for a distance of 2850 metres approximately to a point on the North Eastern boundary of Thomson Gorge Road, thence following in a South Easterly direction the Eastern boundary of Thomson Gorge Road to the intersection with the Northern boundary of Glassford Road, thence crossing the intersection of Racecourse Road with Glassford Road and following the Southern boundary of Naylor Road in a general Westerly direction for a distance of 1500 metres more or less to the intersection with a Public Road and being the Northwestern corner of section 77 in Block V11 Lauder S.D., thence following in a Southwesterly direction the boundary of a Public Road and on a common boundary with sections 77 and 74 for a distance of 1500 metres more or less to the intersection with the Southern boundary of Wallington Road and the Western boundary of Duggan Road, being the point of commencement.

Excluding from within M.I. 32-1204, sections 101 and 81, and part sections 9, 34A and 36 Block V11 Lauder Survey District.



BRONZA BOULDER MINING & DEVELOPMENT CO. LTD.

APPLICATION AREA OUTLINED IN RED

NZMS 261 641 CROMWELL

Scale 1:50 000

Area 380 ha approx

DEVONSHIRE

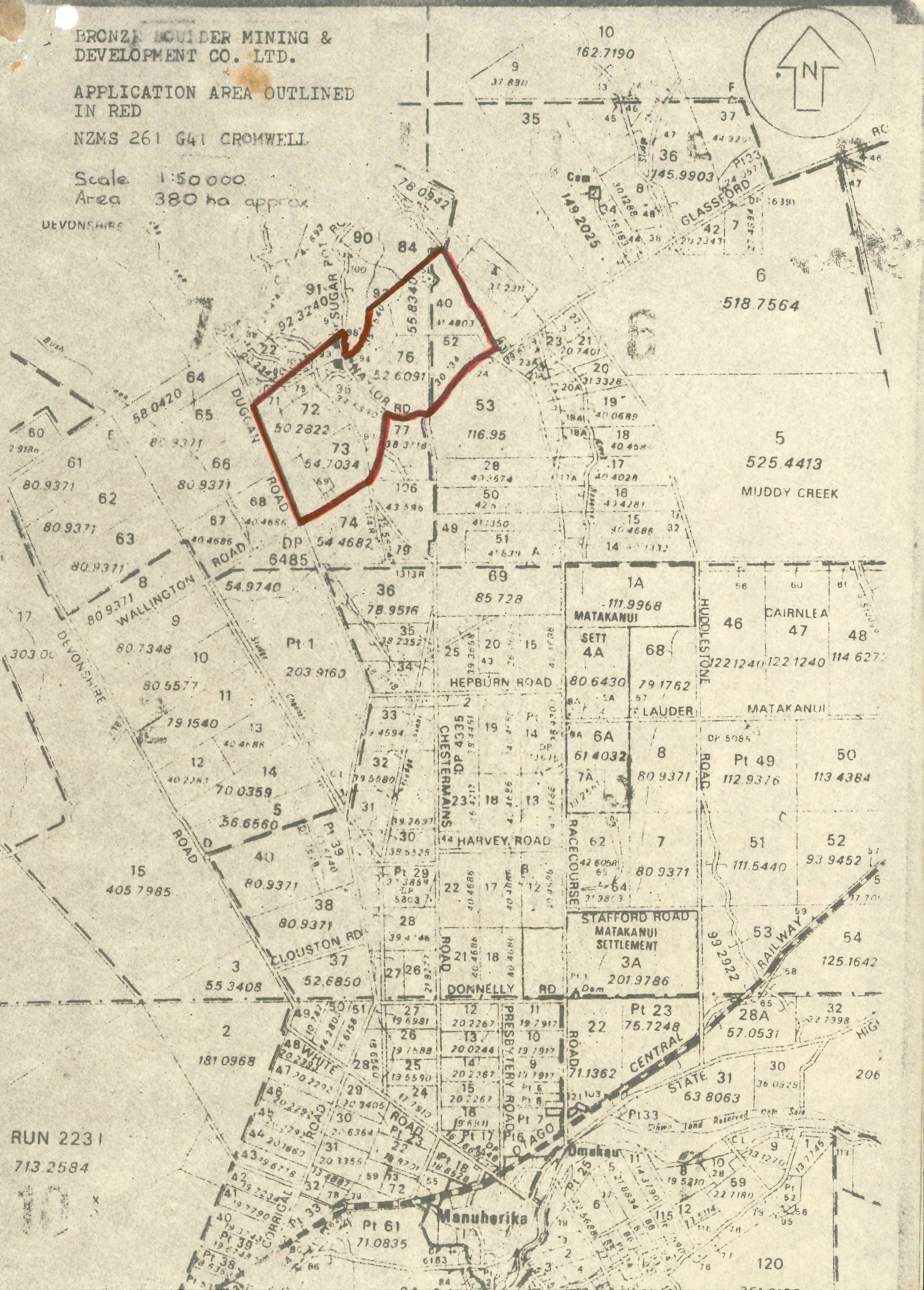
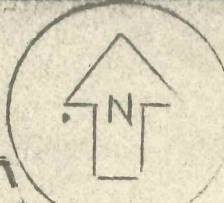

RUN 2231  
713 2584

Manuherika

120