

14/

Department of Lands & Survey,  
P.O.Box 896, DUNEDIN.  
10-7-57

The County ~~Engineer~~/Clerk,  
MANIOTOTO County Council,  
P.O. Box 47,  
Ranfurly.

Dear Sir,

EXEMPTION LAND SUBDIVISION IN COUNTIES ACT, 1946  
Re: *E. 426*

Exemption from the provisions of Section 3(1) of the above Act has been applied for in respect to the above proposed subdivision.

Please advise me as soon as possible whether or not you have any objections to the proposal. Cyclostyled form is ...enclosed.

Yours faithfully,

*Just the 10 acres*

*Charles*  
Chief Surveyor

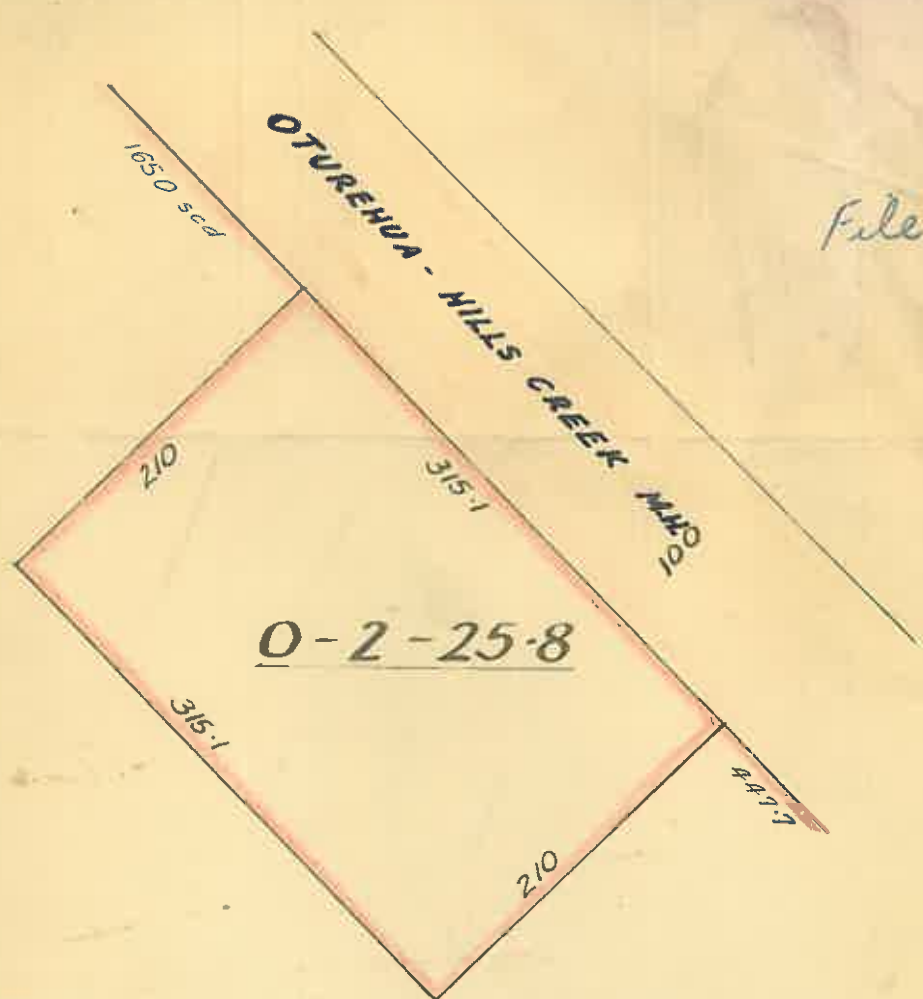

File

BALANCE  
AREA - 139 - 0 - 11.2

PROPOSED SUBDN. OF SEC. 30  
 BLK. I BLACKSTONE S.D.

Comprised in C.L. 102/2

OTAGO LAND DIST.  
 MANIOTOTO COUNTY COUNCIL

Lessee: D.D. Beck Surveyor: E.G. McGeor

Scale: 1 chain to an inch.