

LAND DISTRICT
N.L.C. DISTRICT

VINCENT COUNTY

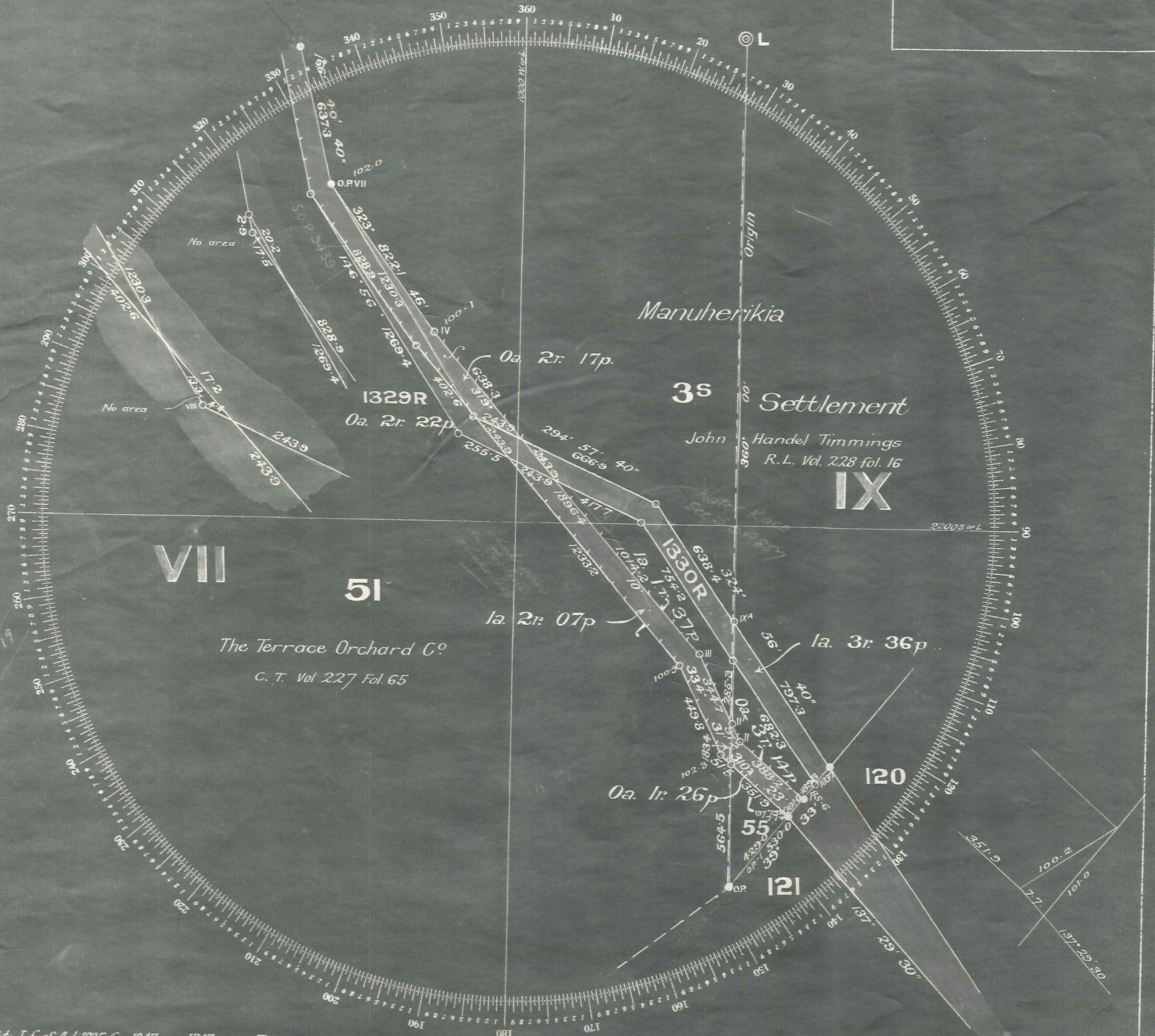

Tracing sent with Return
 for June, 1929
 M.D.

Sec. 1330R Declared subject to L for S. Act. 1925 Gaz. 1947 page 1747
 Closed road coloured green new road coloured red
 Gazette 1929 page 423

Road deviation in Sec. 51 Blk. VII, Sec. 55 Blk. IX and Sec. 35 Manuherikia Settlement LEANING ROCK S. DIST

FILE: IX/148
AUTHORITY:
PARENT PLAN: Manuherikia Sett.
 S.P. 383
REF. PLANS: Wilmots Leaning Rock Bks. VII, IX
Received: 16/3/28 No.
Fieldbook: 1199 page 48
Schedules: BK 12 page 23, 24
Traverse-book: 55 Folio: 31
Examined: [Signature] 1/7/28
Recorded:
Plan in order and ready for approval: Index No 10445

PLAN OF
 Surveyed for Vincent County Council
 By T.G. Phillipps
 Licensed Surveyor.
 Date: January 1928

SCALE: 4 CHAINS TO AN INCH.

I, Thomas George Phillipps of Dunedin
 Licensed Surveyor, hereby certify that this plan has been made from surveys executed by me, that both plan and survey are correct, and have been made in accordance with the regulations of the Surveyor's Board, dated the 20th day of March, 1923.
 Dated at Dunedin this Sixteenth day of August, 1928.

[Signature] I. G. Phillipps
Licensed Surveyor

Approved as from
 Survey agrees with Court order.
 varies from
 [Signature] E. M. Keith C.D.
 for Chief Surveyor.
 419128

Plan No.

10465

L46