

KEY

● Manhole	○ Toby
■ Mudtank	● Soakpit
○ Lamphole	● Hydrant
⊗ Valve	— Blank cap
— Water	— Trickle header
— Sanitary Sewer	— Stormwater Outlet
— Stormwater	CL Cap level
IL Invert level	□ Trickle Control Box

Note: (Unless otherwise stated)

- 1) All Domestic water Laterals 25mm ϕ HDPE.
- 2) All Foul sewer Laterals 100mm ϕ uPVC.
- 3) All Mudtank outlets 200mm ϕ uPVC.
- 4) Trickle irrigation lines 19mm ϕ L.D. polythene with 4mm trickle emitter tubes.
- 5) Level Datum = M.S.L. (Dunedin)

I, James Martin Potter, Registered Surveyor hereby certify that this plan is an accurate Record of the position of the services constructed for this subdivision.

J.M. Potter 2/10/15

PATERSON PITTS PARTNERS LTD
SURVEYING CONSULTANTS
CROMWELL

WAKEFIELD BAY SUBDIVISION ~ ASBUILT OF UNDERGROUND SERVICES

DRAWN		CHECKED	SCALES	SHEET
TRACED		DATE September 1995	1:500	1 of 3
SERIES OF		REF		

DRAWING No. _____
DETAILS _____

AVAILABLE FROM
LEADING OFFICE
EQUIPMENT DE

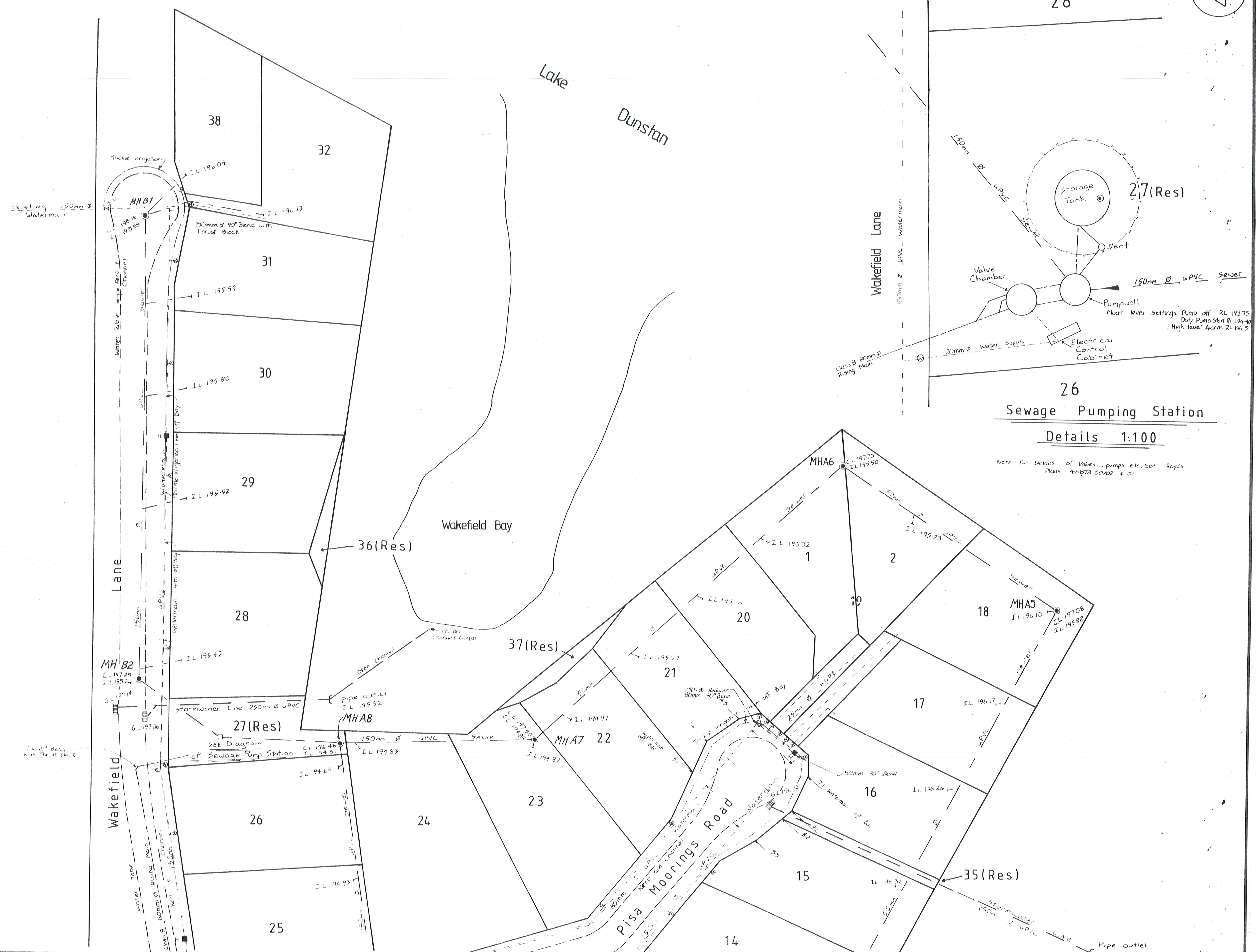
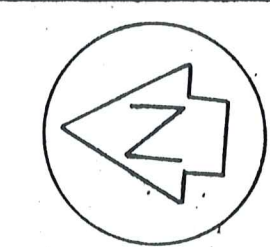

26
Sewage Pumping Station
Details 1:100

Note For Details of Valves, pumps etc. See Roys Plans 46878 00/02 & 01

I, James Martin Potter, Registered Surveyor hereby certify that this plan is an accurate Record of the position of the services constructed for this subdivision.
2/10/95

PATERSON PITTS PARTNERS LTD
SURVEYING CONSULTANTS
CROMWELL

WAKEFIELD BAY SUBDIVISION ~ ASBUILT OF UNDERGROUND SERVICES

See sheet 1 for key.			SHEET
			2 of 3
DRAWN	CHECKED	SCALE	SERIES OF
TRACED	DATE September 1995	1:500	REF

DRAWING NO. _____
DETAILS _____

AVAILABLE FOR LEADING OFF EQUIPMENT D

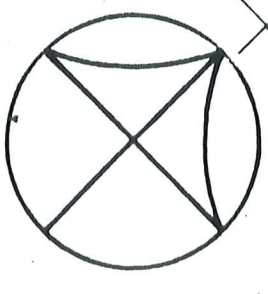

DN

Sec 67

I, James Martin Potter Registered Surveyor
hereby certify that the Watermain shown hereon
is an accurate record of its true position
2/10/95

6x Water storage tanks
Existing 150mm Ø uPVC class B watermain

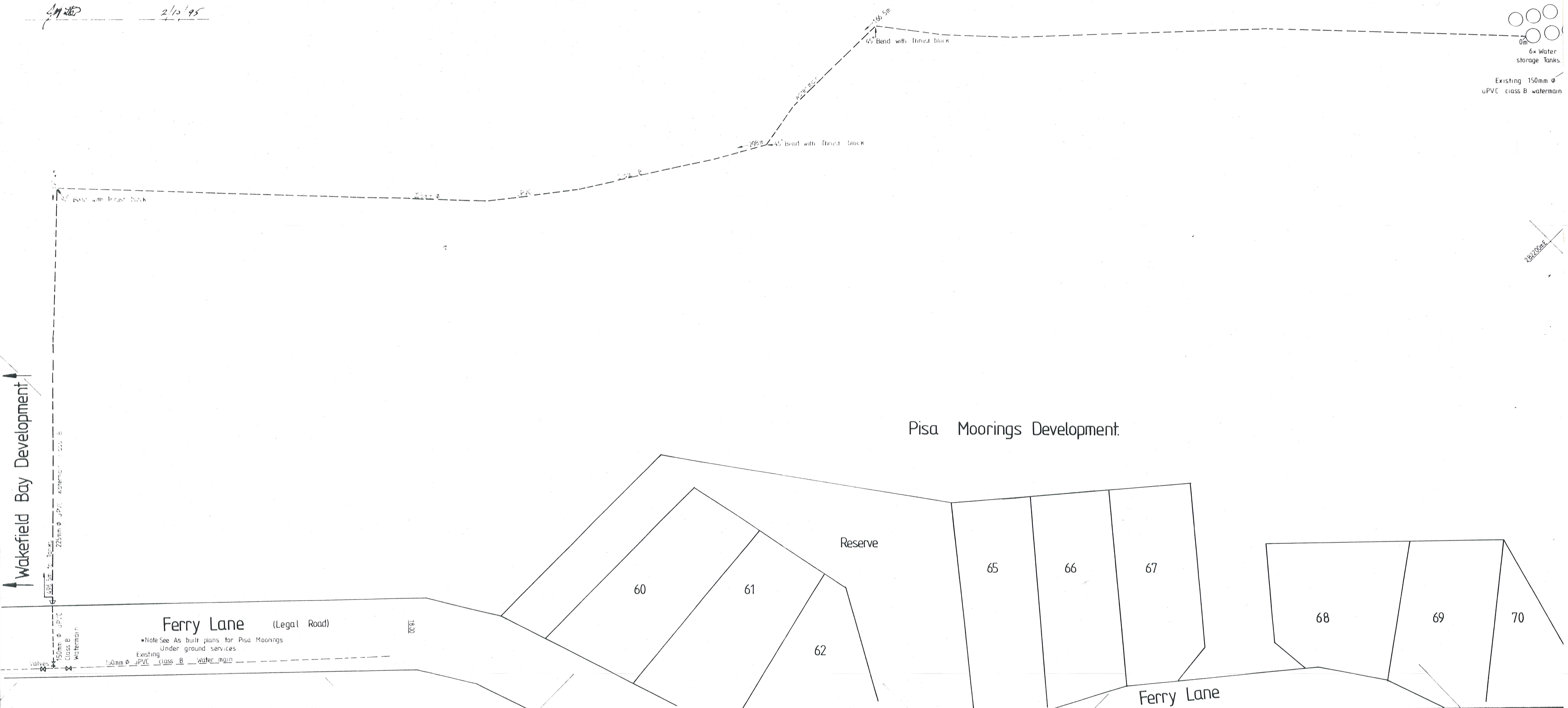

Wakefield Bay Development

Pisa Moorings Development

Ferry Lane (Legal Road)

Reserve

60

61

62

65

66

67

68

69

70

Ferry Lane

PATERSON PITTS PARTNERS LTD
SURVEYING CONSULTANTS
CROMWELL

"As Built" Plan of Wakefield Bay Water Supply

SHEET
3 of 3

DRAWN P.A.B.	CHECKED	SCALE 1:500	SERIES OF
TRACED	DATE Sept 1995		REF

AVAILABLE FOR LEADING OFF EQUIPMENT