

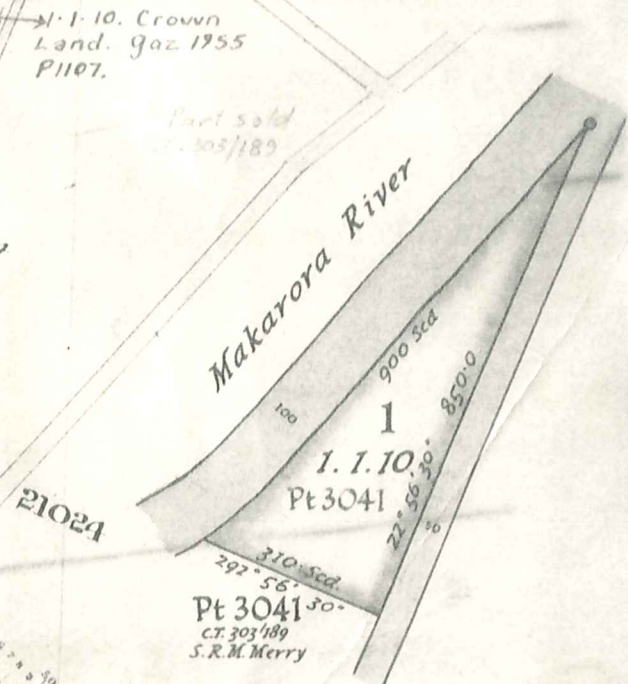

General Survey Department of New Zealand
Provincial District of Canterbury

1433

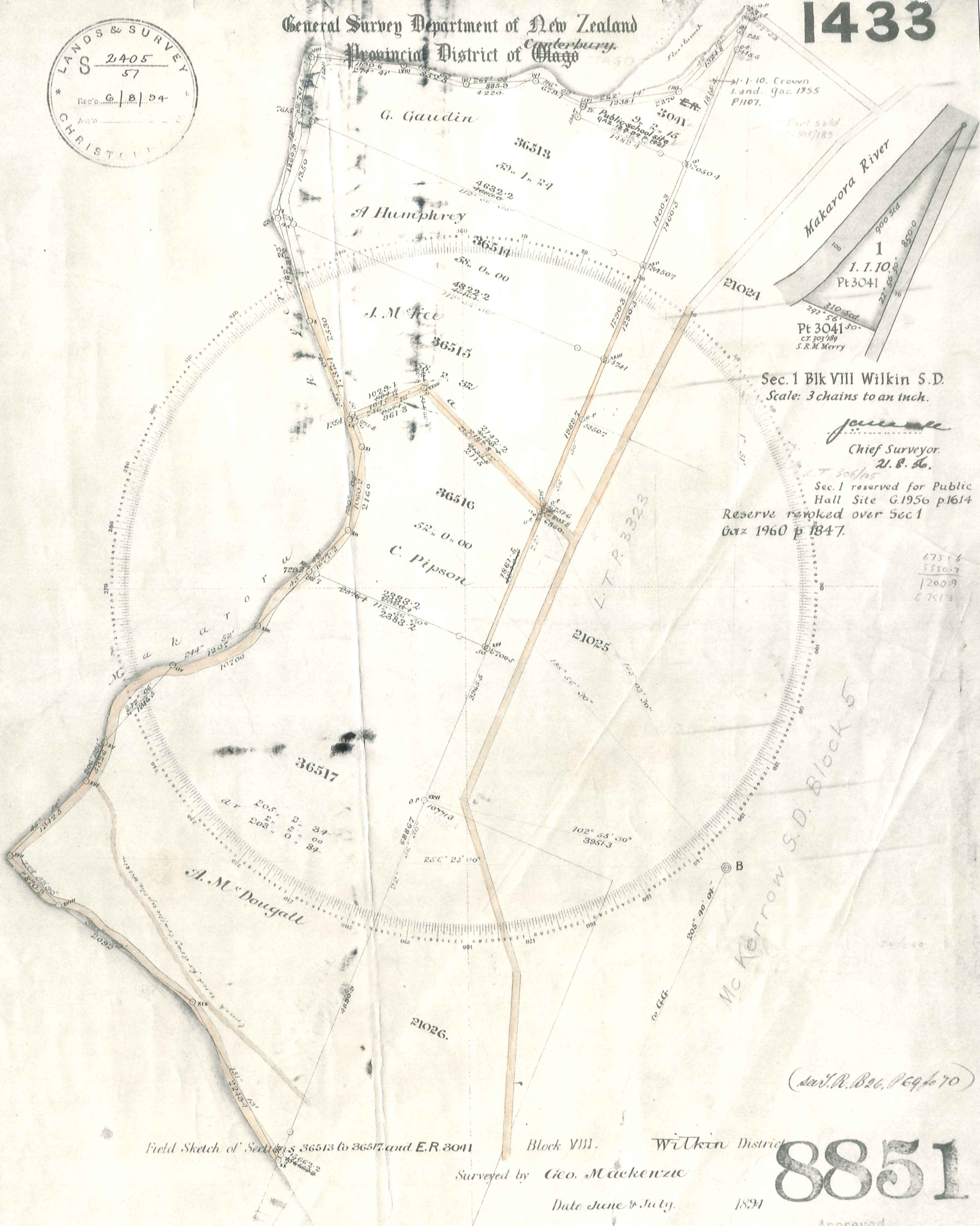

Sec. 1 Blk VIII Wilkin S.D.
Scale: 3 chains to an inch.

Chief Surveyor
21.8.94

Sec. 1 reserved for Public
Hall Site G.1956 p.1614
Reserve revoked over Sec 1
Gaz 1960 p.1847.

6751.6
5550.7
1200.9
6751.5

McKerrow S.D. Block 5

Field Sketch of Sections 36513 to 36517 and E.R. 3041 Block VIII. Wilkin District

Surveyed by Geo. Mackenzie

Date June & July. 1894

Scale 10 Chains to an Inch

8851

Approved
[Signature]

S.2405/57

August 6 '94

NOTE Measured lines to be drawn in red, calculated or scaled lines in black, observed bearings in blue

Copied for Land Office
1893 9.1899