

Approximate Scale 1:5000

DUFFILL WATTS & KING LTD
 CONSULTING CIVIL & STRUCTURAL ENGINEERS
 Dunedin P.O. Box 5269 Ph. 777-133 Invercargill P.O. Box 576 Ph. 83-049
 Alexandra P.O. Box 313 Ph. 6819

MANIOTOTO COUNTY COUNCIL

RANFURLY WATER SUPPLY
 LOCATION OF WORKS.

| AMENDMENTS | | | NAME | | DATE | JOB NO. | Sheet No | |
|------------|----|------|-------|--------------|--------------------|------------|----------|--------|
| NO | BY | DATE | Appvd | Surveyed | | | | |
| | | | | B H & J M | | 10520 | 1 | |
| | | | | Calculations | S Newlands July 84 | | | |
| | | | | Traced | J Murie | | | |
| | | | | Checked | | | | |
| | | | | Approved | | | | |
| | | | | | | File c/e/s | LB. SOB | F.B. ~ |

ORIGINAL SIZE
mm INCHES

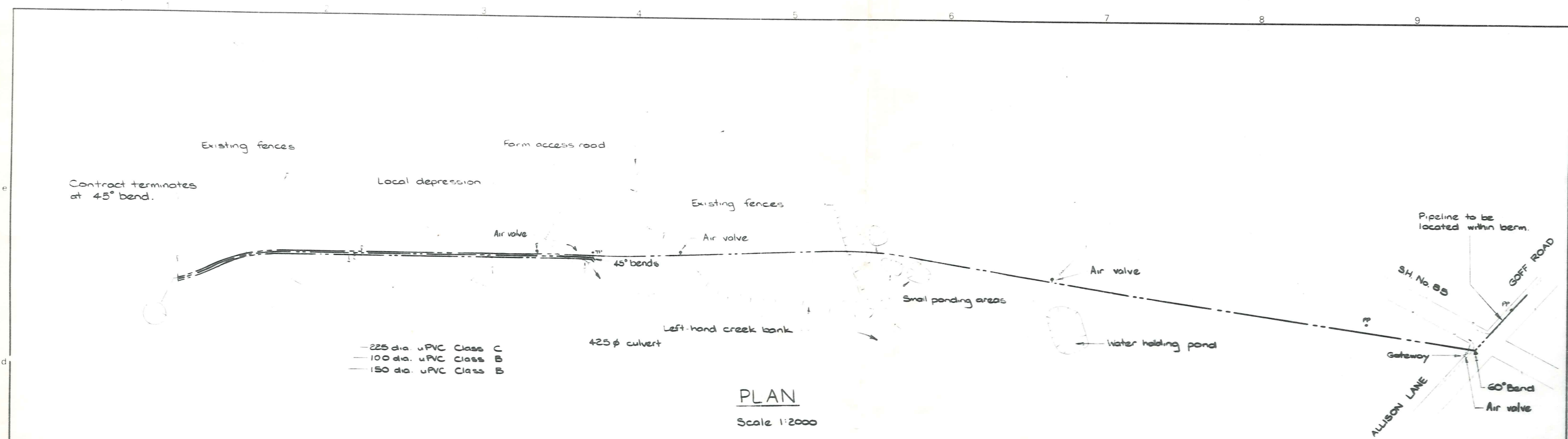

PLAN
Scale 1:2000

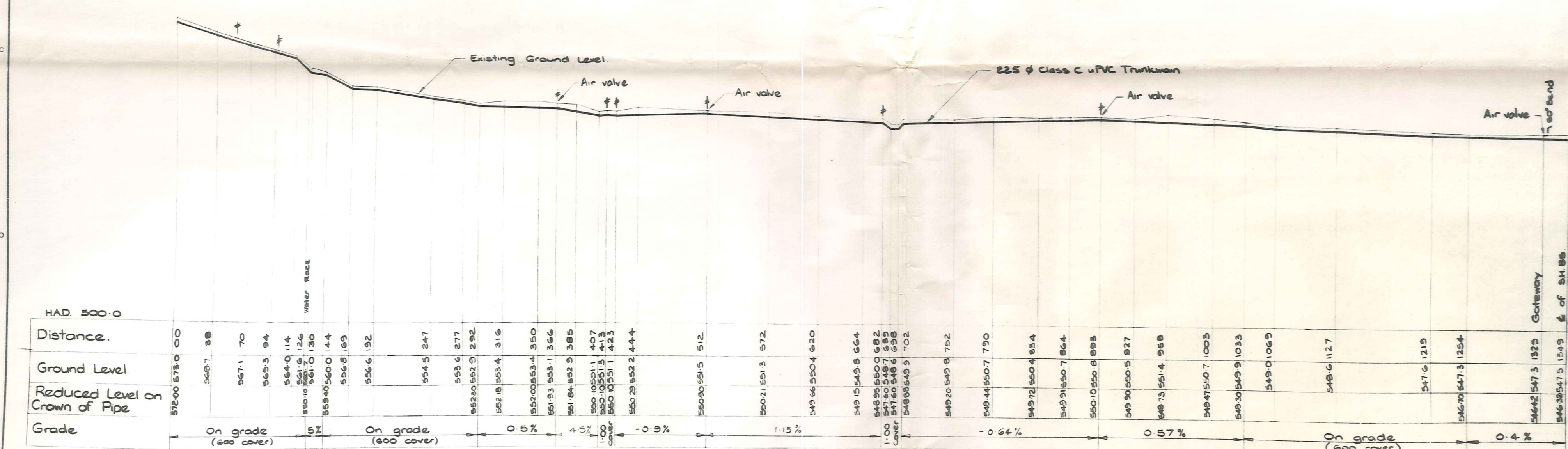

LONGITUDINAL SECTION
Scales 1:2000 H
1:500 V

Minimum cover in all circumstances = 600mm.

| | | | | | | | |
|---|---------------------------------|---|------------|----|--|-------------------------|--------------------------------------|
| DUFFILL WATTS & KING LTD CONSULTING CIVIL & STRUCTURAL ENGINEERS Dunedin P.O. Box 5269 Ph. 777 133 Invercargill P.O. Box 576 Ph. 83 049 Alexandra P.O. Box 313 Ph. 8819 | MANIOTOTO COUNTY COUNCIL | RANFURLY WATER SUPPLY TRUNK MAIN LOCATION AND ELEVATION | AMENDMENTS | | NAME DATE Surveyed J. Mune June 84 Drawn " Calculations S. Newlands July 84 Traced J. Mune " Checked S. Munn " Approved " Appvd | JOB NO. 10520 | Sheet No. 2 of 8 sheets |
| | | | NO | BY | | | |

ORIGINAL SIZE INCHES

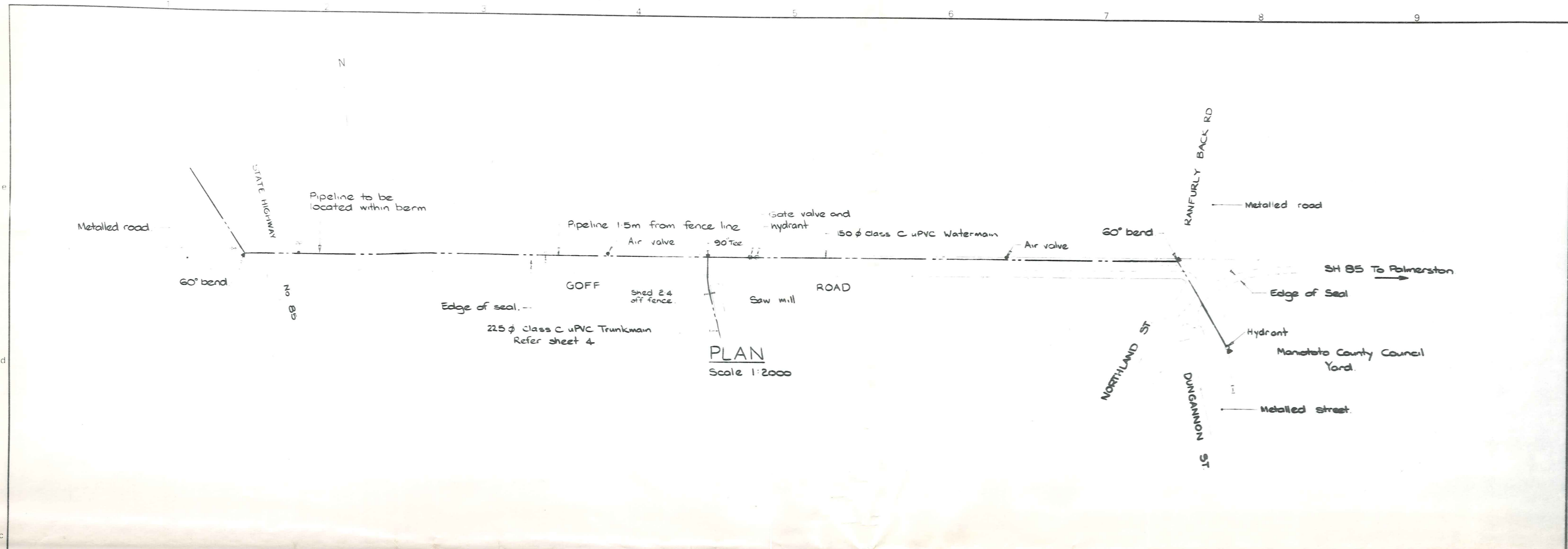

PLAN
Scale 1:2000

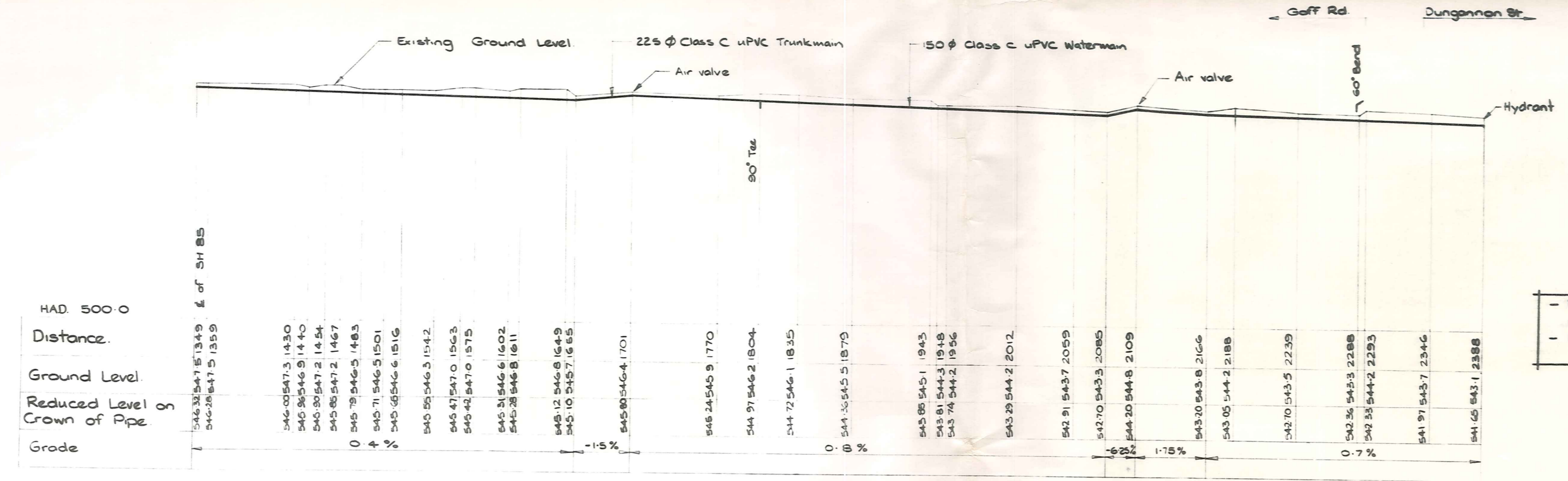

LONGITUDINAL SECTION

Scales 1:2000 H
1:500 V

HAD. 500.0

| Distance. | Ground Level. | Reduced Level on Crown of Pipe. | Grade |
|-----------|---------------|---------------------------------|------------|
| 546.32 | 547.15 | 547.15 | 1 of SH 85 |
| 546.28 | 547.5 | 547.5 | |
| 546.02 | 547.3 | 547.3 | |
| 545.98 | 546.9 | 546.9 | |
| 545.80 | 547.2 | 547.2 | |
| 545.85 | 547.2 | 547.2 | |
| 545.79 | 546.5 | 546.5 | 0 |
| 545.71 | 546.5 | 546.5 | 4 |
| 545.65 | 546.6 | 546.6 | 1.5 |
| 545.55 | 546.3 | 546.3 | |
| 545.47 | 547.0 | 547.0 | |
| 545.42 | 547.0 | 547.0 | |
| 545.31 | 546.6 | 546.6 | |
| 545.28 | 546.8 | 546.8 | |
| 545.12 | 546.8 | 546.8 | |
| 545.10 | 545.7 | 545.7 | |
| 545.00 | 546.4 | 546.4 | |
| 546.24 | 545.9 | 545.9 | 1.770 |
| 544.97 | 546.2 | 546.2 | 1.804 |
| 544.72 | 546.1 | 546.1 | 1.835 |
| 544.35 | 545.5 | 545.5 | 1.873 |
| 543.88 | 545.1 | 545.1 | 1.943 |
| 543.81 | 544.3 | 544.3 | 1.948 |
| 543.74 | 544.2 | 544.2 | 1.956 |
| 543.29 | 544.2 | 544.2 | 2.012 |
| 542.91 | 543.7 | 543.7 | 2.059 |
| 542.70 | 543.3 | 543.3 | 2.085 |
| 544.20 | 544.8 | 544.8 | 2.109 |
| 543.70 | 543.8 | 543.8 | 2.166 |
| 543.05 | 544.2 | 544.2 | 2.188 |
| 542.70 | 543.5 | 543.5 | 2.239 |
| 542.36 | 543.3 | 543.3 | 2.286 |
| 542.35 | 544.2 | 544.2 | 2.293 |
| 541.97 | 543.7 | 543.7 | 2.346 |
| 541.65 | 543.1 | 543.1 | 2.388 |

- Minimum cover under Carriageway = 800 mm
- Minimum cover elsewhere = 600 mm.

DUFFILL WATTS & KING LTD
CONSULTING CIVIL & STRUCTURAL ENGINEERS
Dunedin P.O. Box 2249 Ph. 771-133 Invercargill P.O. Box 576 Ph. 83 044
Alexandra P.O. Box 313 Ph. 88 614

MANIOTOTO COUNTY COUNCIL

RANFURLY WATER SUPPLY TRUNK MAIN LOCATION AND ELEVATION

| AMENDMENTS | | | NAME | DATE | JOB NO. | Sheet No. | | |
|------------|----|------|-------|--------------|------------|-----------|------------|----------|
| NO. | BY | DATE | | | 10520 | 3 | | |
| | | | Appvd | Surveyed | | | B Hawkins | May '84 |
| | | | | Drawn | | | | |
| | | | | Calculations | | | B Newlands | July '84 |
| | | | | Traced | | | J Munn | |
| | | | | Checked | G Newlands | | | |
| | | | | Approved | | | | |

File 6/6/8 LB 508 FB ~

ORIGINAL SIZE
mm INCHES

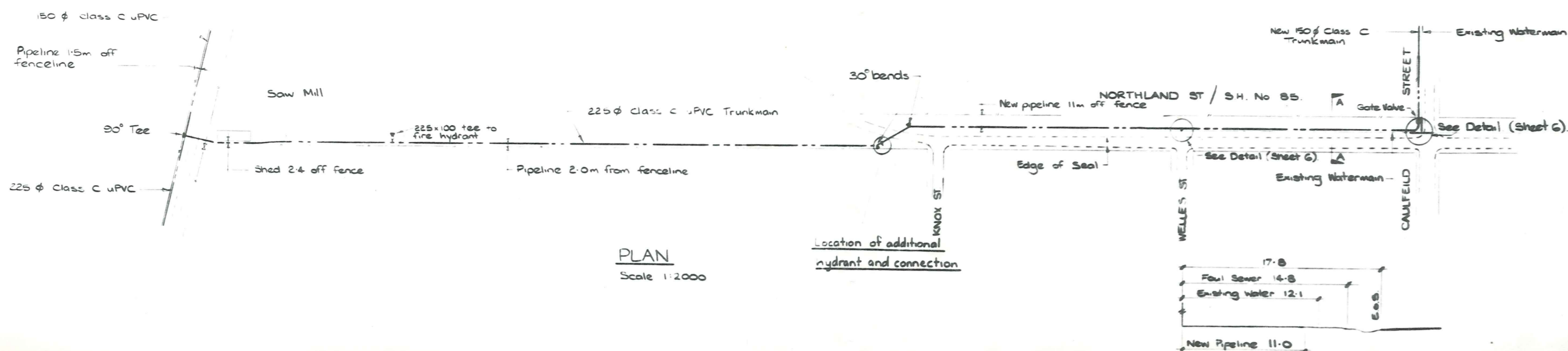

PLAN
Scale 1:2000

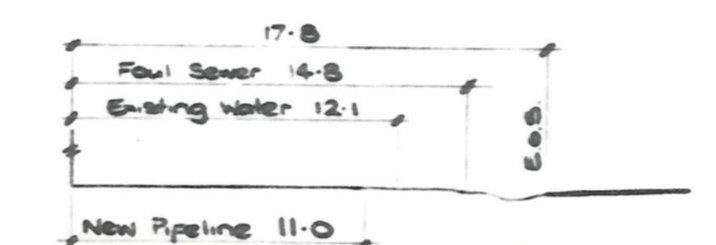

Section A-A
Scale 1:20

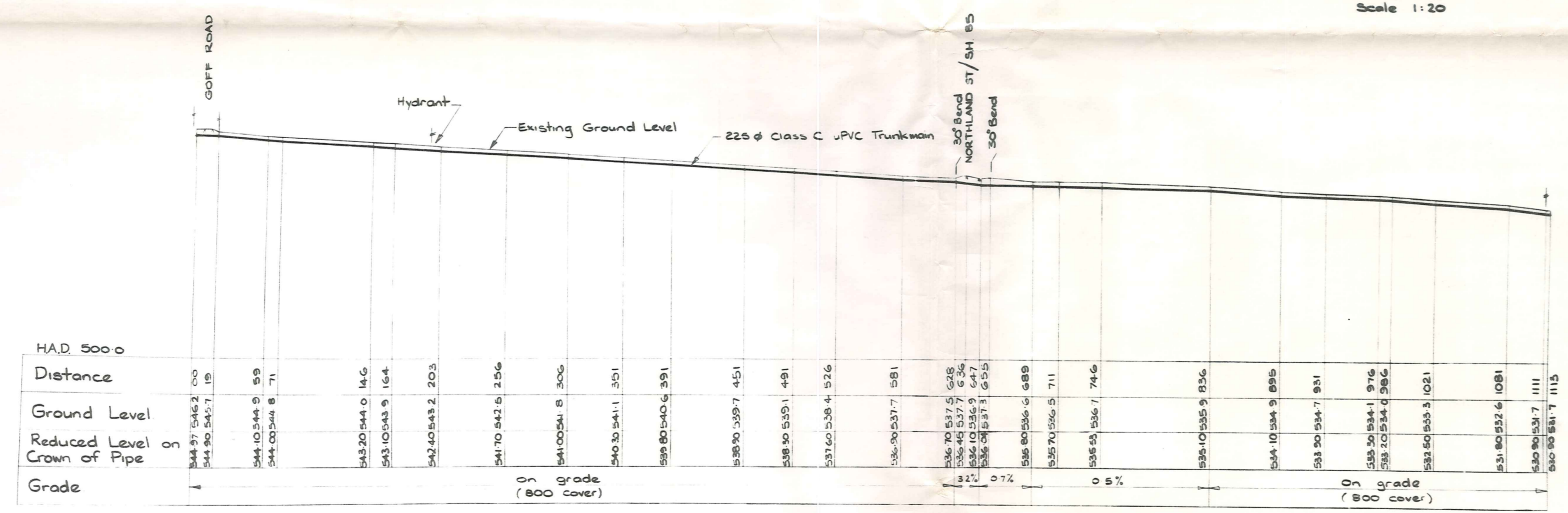

LONGITUDINAL SECTION

Scales 1:2000 H
1:500 V

Minimum cover in all circumstances = 800mm.

DUFFILL WATTS & KING LTD
CONSULTING CIVIL & STRUCTURAL ENGINEERS
Dunedin P.O. Box 2269 Ph. 777 133 Invercargill P.O. Box 576 Ph. 83 049
Alexandra P.O. Box 313 Ph. 68 19

MANIOTOTO
COUNTY COUNCIL

RANFURLY WATER SUPPLY
TRUNK MAIN LOCATION AND ELEVATION

| AMENDMENTS | | | NAME DATE | | JOB NO. | Sheet No | |
|------------|----|---------|-----------|-------------|------------|----------|---------|
| NO. | BY | DATE | Appvd | Surveyed | 10520 | 4/A | |
| A | SM | 24/4/86 | | J.M. & T.B. | | | July 84 |
| | | | | J. Murie | | | |
| | | | | S. Newlands | | | |
| | | | | J. Murie | | | |
| | | | Checked | S. Newlands | File 6/6/3 | LB 508 | |
| | | | Approved | | | FB ~ | |

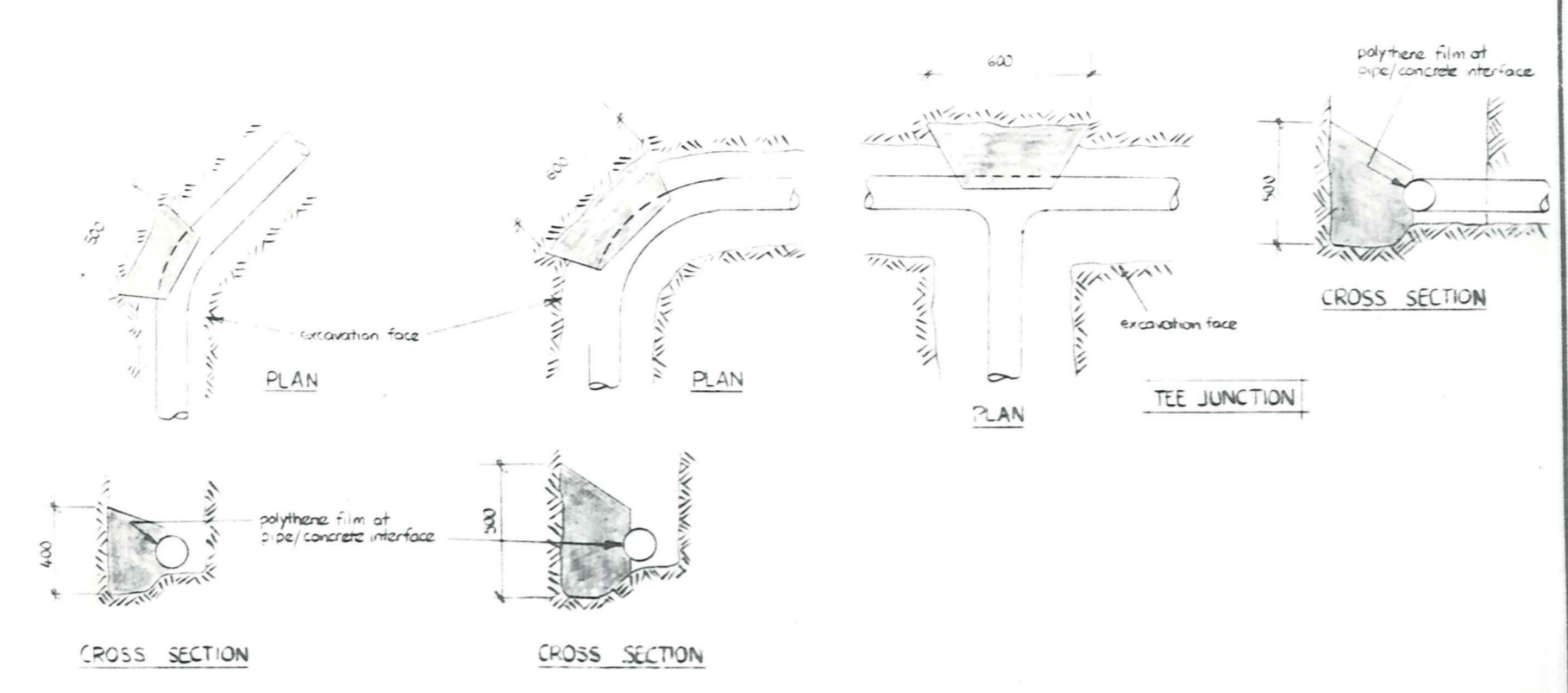
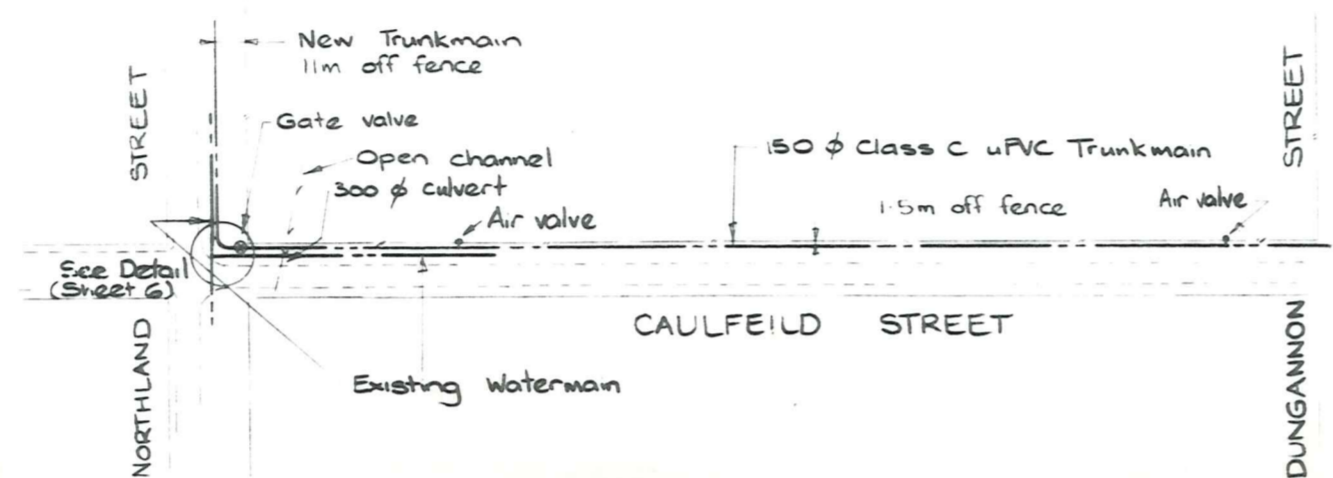

TYPICAL ANCHOR BLOCK DETAILS
NOT TO SCALE

Minimum cover in all circumstances = 750 mm.

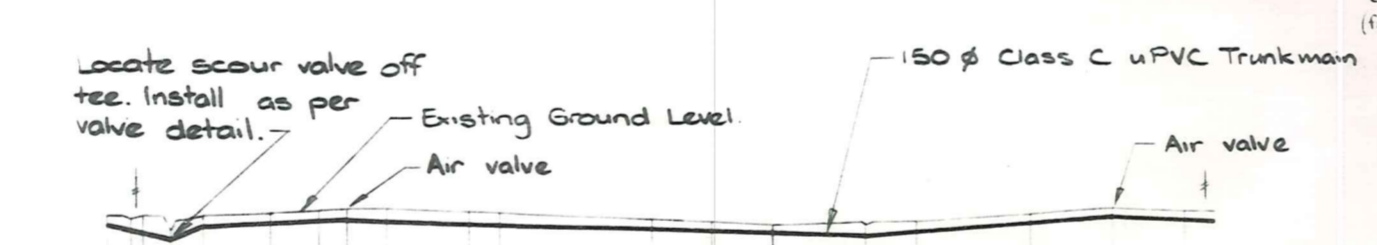

HAD 500 0
Distance
Ground Level
Reduced Level of Crown of Pipe
Grade

| | | |
|-----|--------------|-----|
| 0 | 530 94 5317 | 0 |
| 9 | 5315 | 9 |
| 14 | 5317 | 14 |
| 24 | 530 64 5303 | 24 |
| 37 | 530 89 5316 | 37 |
| 62 | 531 12 5319 | 62 |
| 81 | 531 37 5322 | 81 |
| 81 | 531 50 5322 | 81 |
| 106 | 531 36 5322 | 106 |
| 137 | 531 08 5321 | 137 |
| 149 | 530 97 5319 | 149 |
| 206 | 530 44 5312 | 206 |
| 229 | 530 28 5310 | 229 |
| 282 | 530 00 530 8 | 282 |
| 287 | 529 70 530 5 | 287 |
| 306 | 530 03 530 9 | 306 |
| 349 | 530 77 531 6 | 349 |
| 380 | 531 30 532 1 | 380 |
| 407 | 531 08 531 9 | 407 |
| 418 | 531 00 531 8 | 418 |

Grades: -1.5%, 0.92%, -1.7%, 1%

WATERMAIN ALONG CAULFEILD ST.

Scales 1: 2000 H
1: 500 V

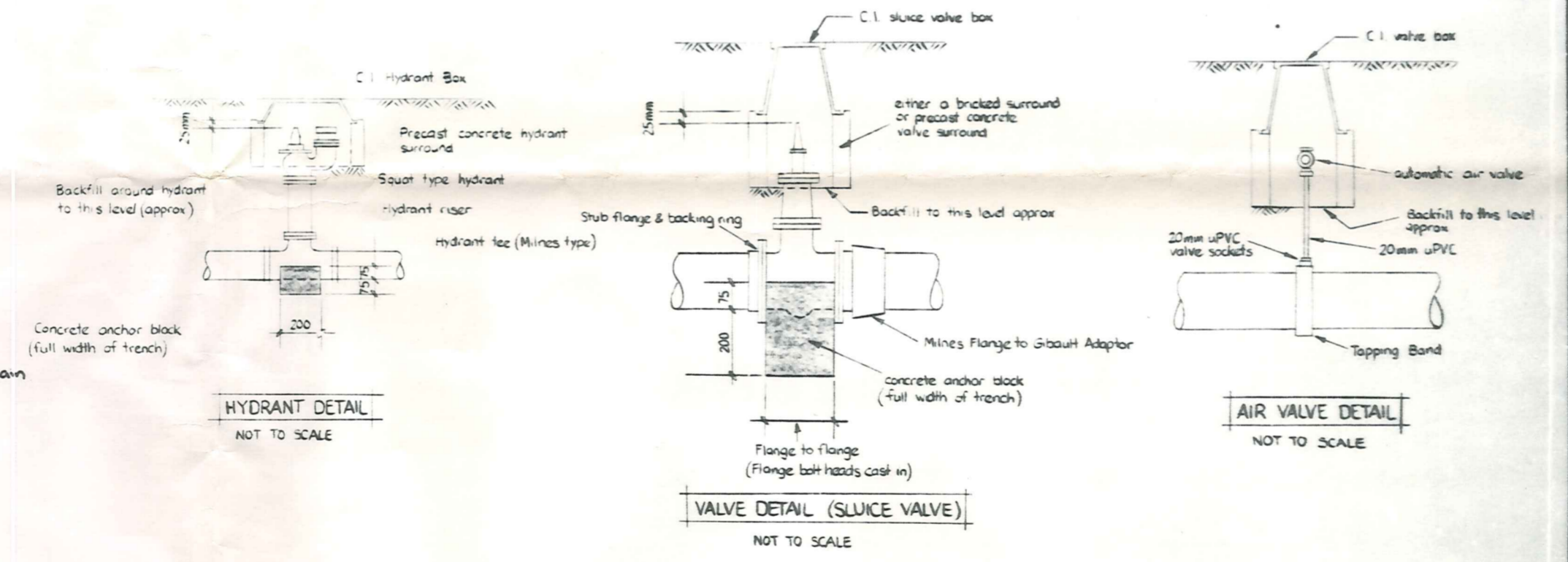

HYDRANT DETAIL
NOT TO SCALE

VALVE DETAIL (SLUCE VALVE)
NOT TO SCALE

AIR VALVE DETAIL
NOT TO SCALE

* Refer to specific drawings for cover to pipe crown.

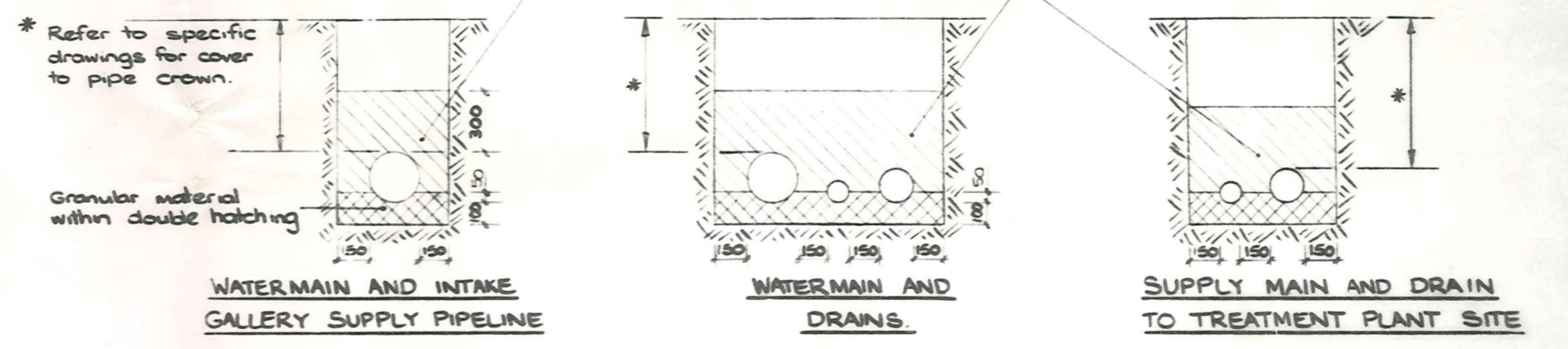

WATERMAIN AND INTAKE GALLERY SUPPLY PIPELINE

WATERMAIN AND DRAINS

SUPPLY MAIN AND DRAIN TO TREATMENT PLANT SITE

| AMENDMENTS | | NAME | DATE | JOB NO. | Sheet No |
|------------|----|------|------------------------------|------------|---------------|
| NO. | BY | DATE | | 10520 | 5 of 8 sheets |
| | | | Appvd | | |
| | | | Surveyed J.M. & T.B. July 84 | | |
| | | | Drawn J. Murie | | |
| | | | Calculations S. Newlands | | |
| | | | Traced J. Murie | File 6/6/3 | LB 50B |
| | | | Checked S. Newlands Aug | | |
| | | | Approved J. Murie | | |

ORIGINAL SIZE
mm INCHES

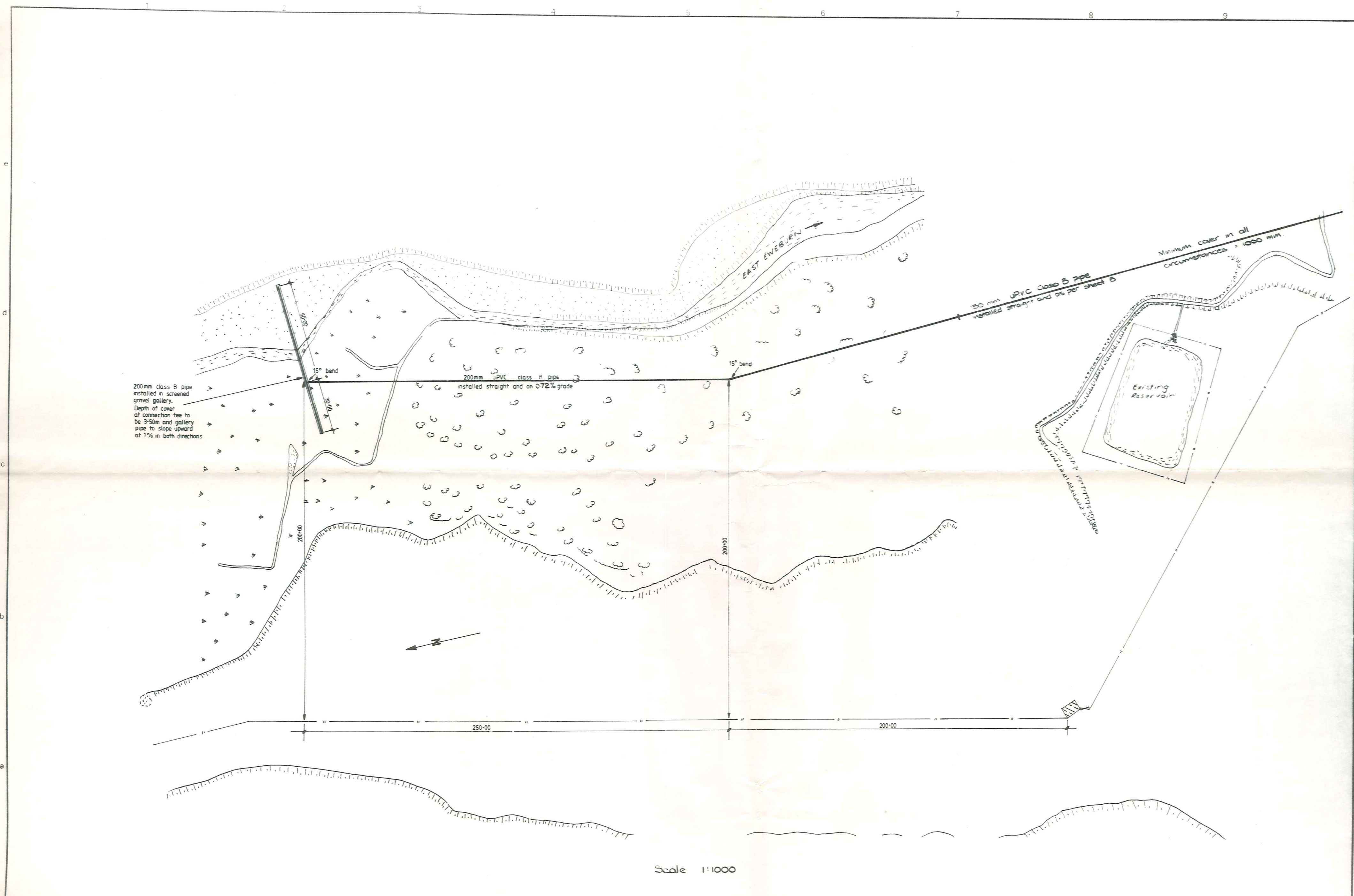

Scale 1:1000

DUFFILL WATTS & KING LTD
CONSULTING CIVIL & STRUCTURAL ENGINEERS
Dunedin P.O. Box 2269 Ph. 777-133 Invercargill P.O. Box 576 Ph. 83-049
Alexandra P.O. Box 313 Ph. 68-19

**MANIOTOTO
COUNTY COUNCIL**

**RANFURLY WATER SUPPLY
INTAKE GALLERY & SUPPLY PIPELINE**

| AMENDMENTS | | NAME | DATE | JOB NO. | Sheet No |
|------------|----|------|-------|--------------|----------------|
| NO. | BY | DATE | Appvd | Surveyed | B Hawkins |
| | | | | Drawn | Nov 1981 |
| | | | | Calculations | S Newlands |
| | | | | Traced | M Potter |
| | | | | Checked | S. [Signature] |
| | | | | Approved | [Signature] |
| | | | | File | 6/6/83 |
| | | | | L.B. | - |
| | | | | F.B. | ~ |
| | | | | of 2 sheets | 7 |

Blank off and install temporary thrust blocks or connect to new reservoir pipework if installed.

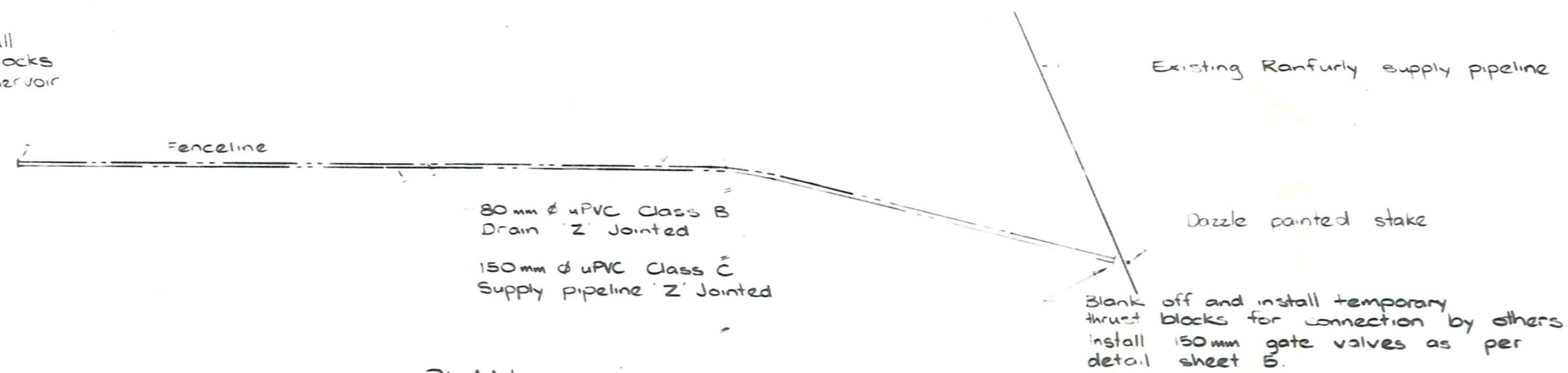

PLAN
Scale 1:2000

Fig A and existing fence line (being replaced)

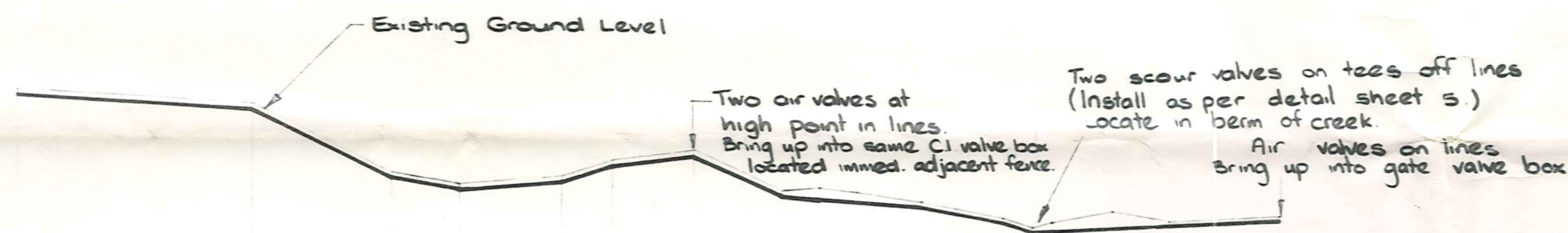

| | |
|--------------------------------|---------|
| HAD | 500.00 |
| Distance | 5760.00 |
| Ground Level | 35 |
| Reduced Level on Crown of Pipe | |
| Grade | |

| | | | | | | | | | | | | | | | |
|----------------------|-----------|--------------------------|-----------|----------------------|-----------|------------------------------|-----------|-----------|------------------|-----------|-----------------|-----------|-----------|-----------|-----------------|
| 5743.141 | 566.8.203 | 565.4.233 | 566.1.280 | 568.0.302 | 569.2.358 | 564.0.364.6.378 | 565.0.396 | 564.4.413 | 562.70.563.3.442 | 561.6.479 | 560.0.560.5.492 | 561.2.501 | 562.4.529 | 561.4.554 | 561.3.561.9.604 |
| on grade (600 cover) | | 2% grade (600 min cover) | | on grade (600 cover) | | -11.6% grade (600 min cover) | | | | | | | | | |

Minimum cover in all circumstances = 600mm.

SUPPLY AND OUTWASH PIPELINES

Section Scales
1:2000 H
1:500 V

Legend

- 1 225 x 150 uPVC fabricated tee
- 2 150 # M.ines flange to gibault adaptor
- 3 150 # flanged gate valve
- 4 150 # C.I. equal tee
- 5 150/100 C.I. reducer
- 6 100 # C.I. flange adaptor
- 7 100 # gibault couplings
- 8 225/150 uPVC fabricated reducing socket
- 9 150 # uPVC formed bend
- 10 150 # uPVC stub flange and backing ring

CONNECTION OF NEW WATERMAIN TO EXISTING MAIN AT DUNGANNON/CAULFIELD ST.

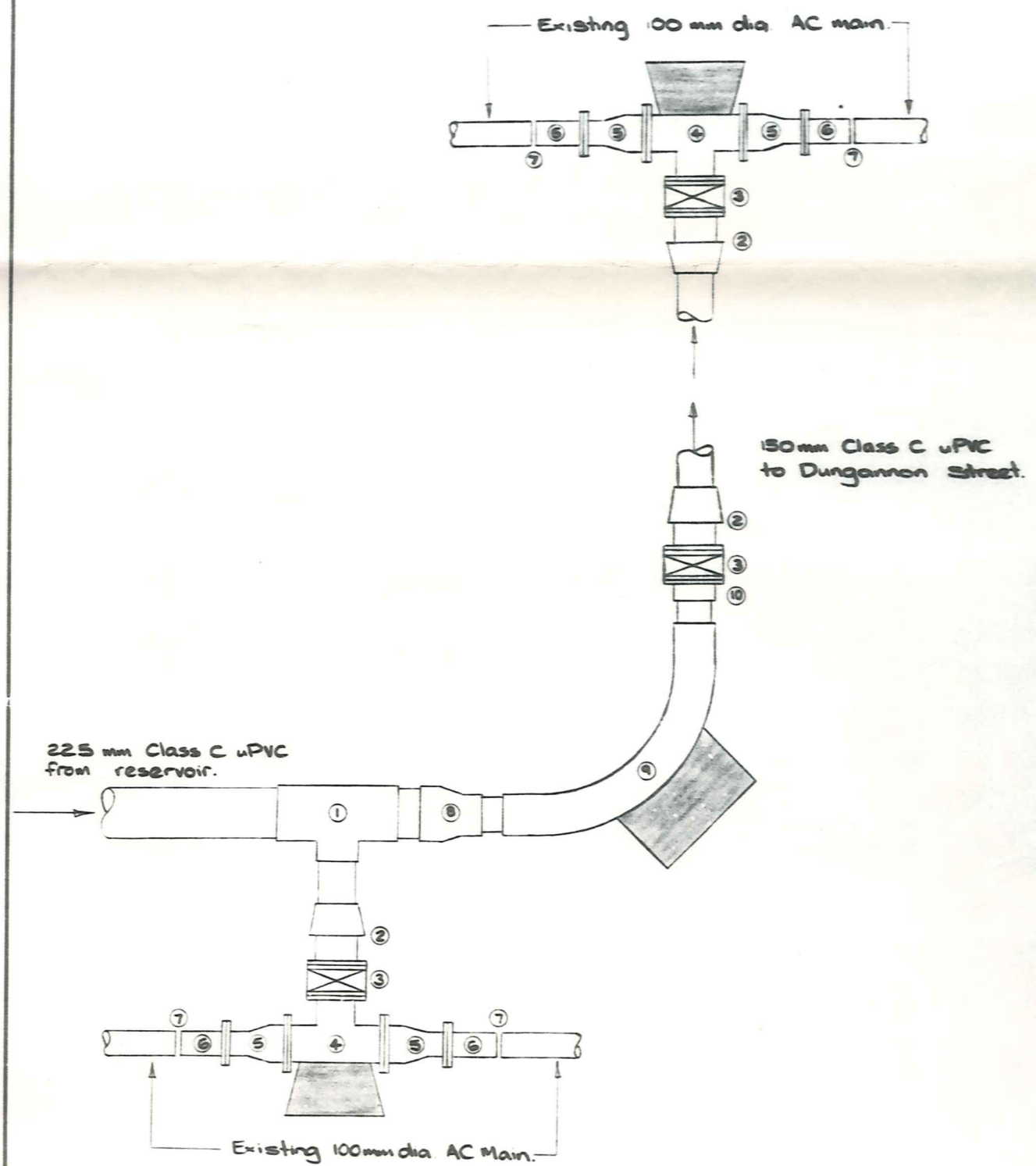

CONNECTION OF NEW WATER MAIN TO EXISTING MAIN AT NORTHLAND/CAULFIELD ST.
(CONNECTION AT WELLS STREET SIMILAR).

DUFFILL WATTS & KING LTD
CONSULTING CIVIL & STRUCTURAL ENGINEERS
Dunedin P.O. Box 5265 Ph: 777 133 Invercargill P.O. Box 576 Ph: 83 049
Alexandra P.O. Box 313 Ph: 6819

MANIOTOTO
COUNTY COUNCIL

RANFURLY WATER SUPPLY.
RESERVOIR SITE TO EXISTING SUPPLY MAIN

| AMENDMENTS | | NAME | | DATE | JOB NO. | Sheet No |
|------------|--------|----------|-------------------------|--------------|------------|----------|
| NO. | BY | DATE | APPROV | SURVEYED | B Hawkins | May '84 |
| 1 | J.M.L. | 23/02/84 | RELOCATION OF PIPELINES | DRAWN | J. Murie | July '84 |
| | | | | CALCULATIONS | S Newlands | |
| | | | | TRACED | J. Murie | |
| | | | | CHECKED | S. Hawkins | |
| | | | | APPROVED | | |

10520
6A
of 8 sheets
File 6/6/8 LB 508 FB ~