

NOTE
THE EXACT ALIGNMENT FOR THE REPLACEMENT RISING MAIN WILL BE CONFIRMED ON SITE BY THE ENGINEER FOLLOWING EXPLORATORY WORK BY THE CONTRACTOR TO CONFIRM THE LOCATION AND LEVEL OF EXISTING SERVICES.

SERVICES LEGEND	
---	UNDERGROUND POWER
---	FOUL SEWER
---	STORMWATER
---	TELECOM
---	WATER

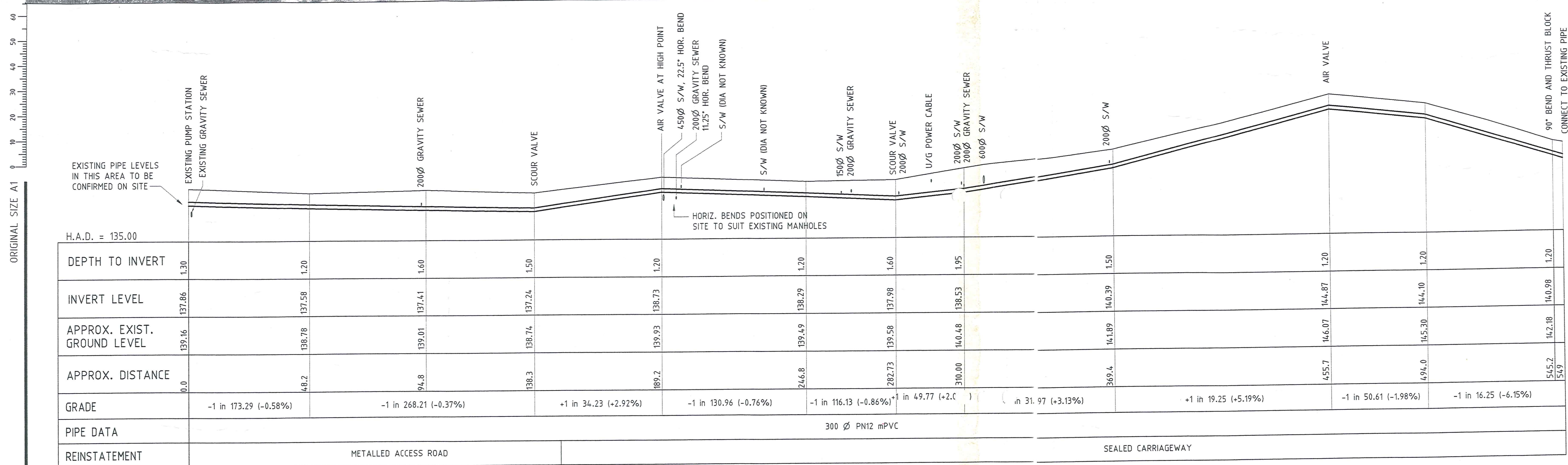

NOTE
1. LEVELS IN TERMS OF MSL.
BENCHMARK ON NORTH ABUTMENT WALL, UNDERSIDE OF CLUTHA RIVER BRIDGE RL 139.51

LONGSECTION ALONG LINE OF REPLACEMENT SEWERAGE RISING MAIN
1 : 1000 H, 1 : 200 V

REV	DATE	BY	INITIAL	REASON
0	11.8.99	PNJ		FOR TENDER

CAD REF : J:\18000-18900\12\Cad\90012-01
XREFS : XREF1
COPYRIGHT ©
These drawings shall only be used for the purpose for which they were supplied. Any re-use is prohibited and no part of this document may be reproduced or distributed without the written permission of Montgomery Watson New Zealand Ltd.

FIELDBOOK	Name	Date
SURVEYED	MW/BALC.	7/99
DESIGNED	NJ	7/99
DRAWN	PAT	7/99
CHECKED	NJ	8/99
APPROVED	P JACOBSON	11/8/99

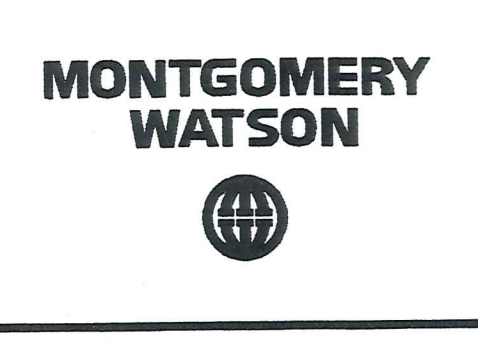

CONTRACT No. 99/103
RIVERS STREET PUMPING MAIN REPLACEMENT
PLAN AND LONGSECTION

Status Stamp	FOR APPROVAL		
Date Stamp	10 AUG 1999		
SCALES	AS SHOWN		
Job No.	Sheet No.	Rev.	
18900.12.01	01	0	