

WINGWALL ELEVATION.
SHOWING REINFORCING OF BACK FACE

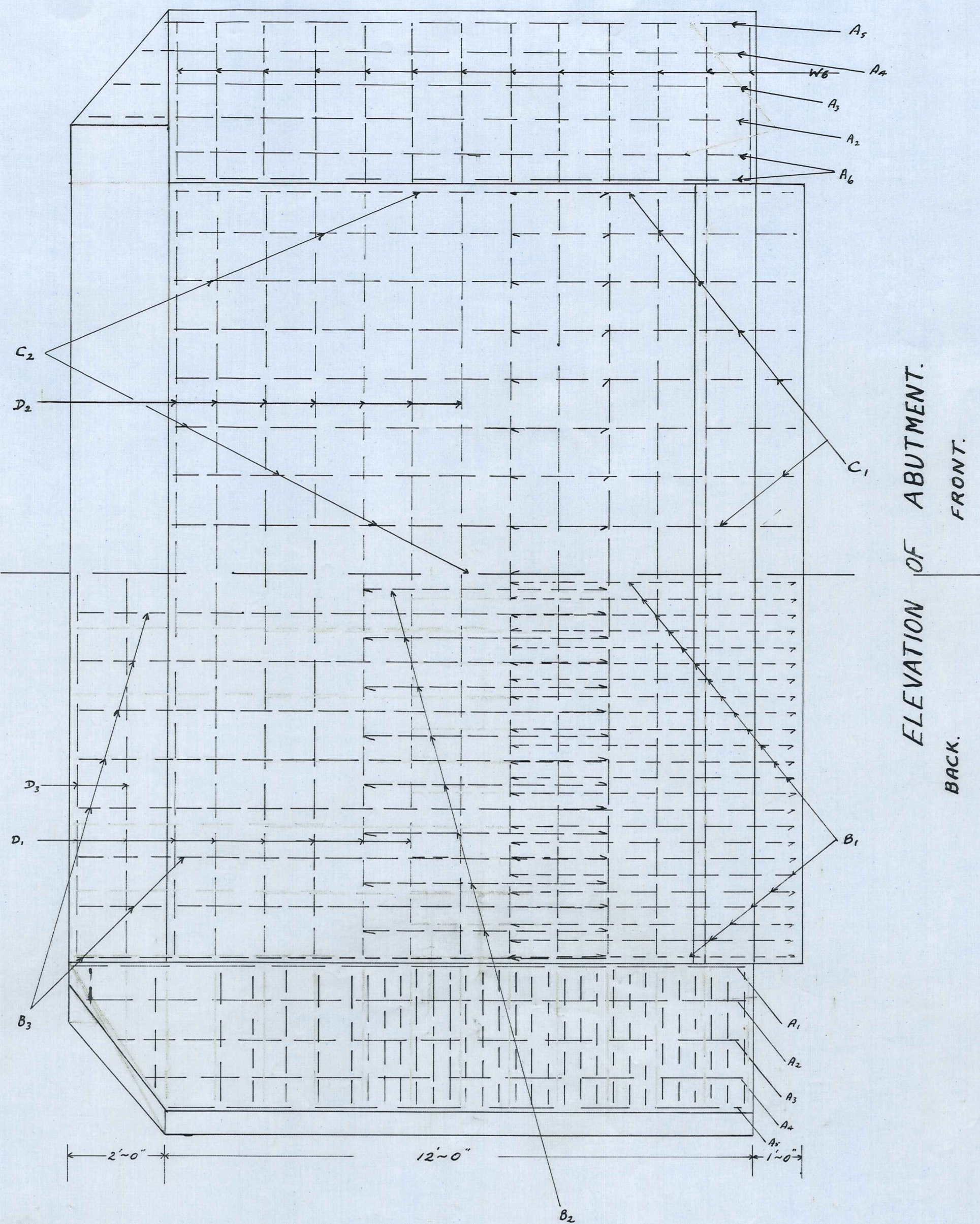

ELEVATION OF ABUTMENT.
FRONT.
BACK.

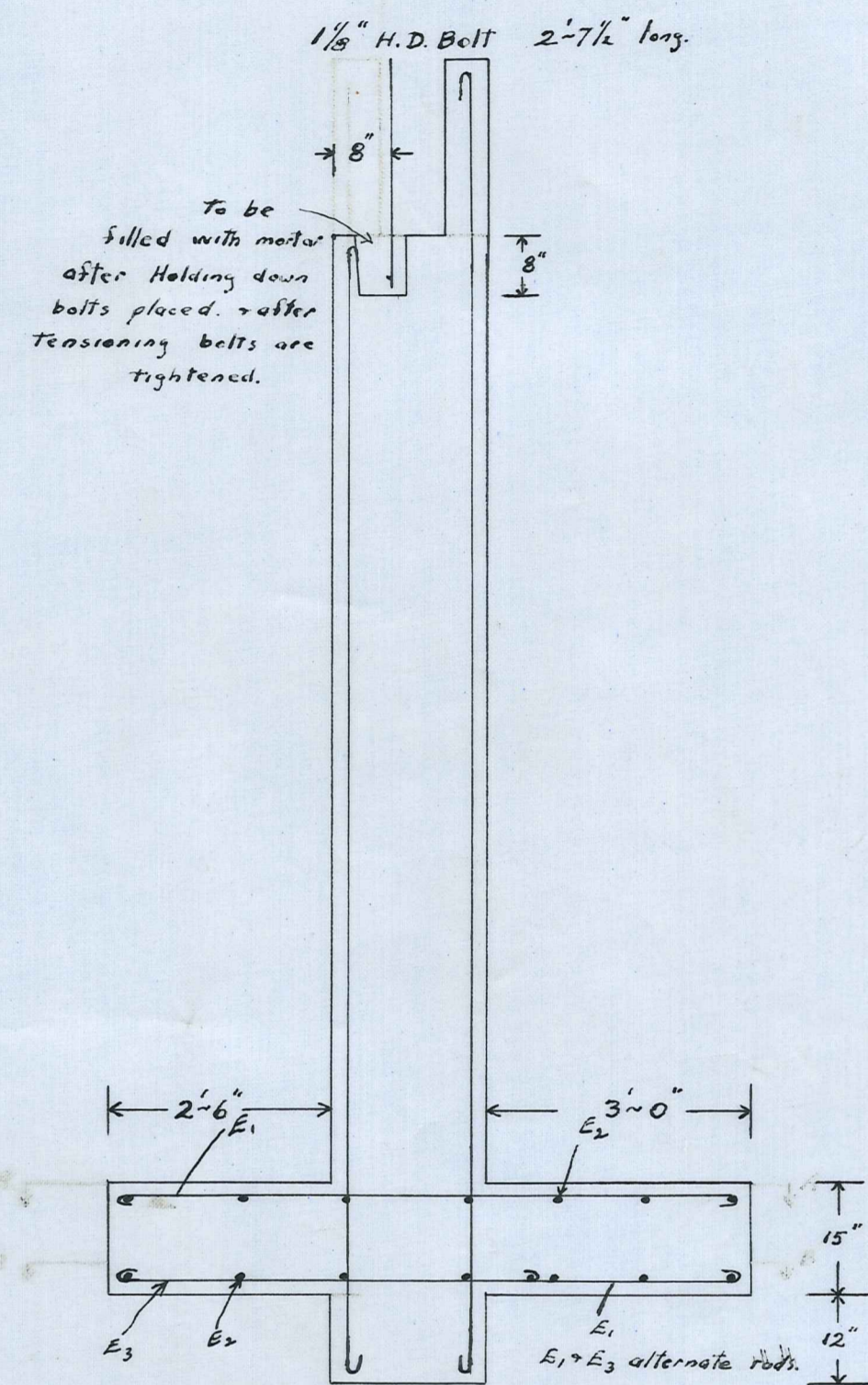

Section A-A of Abutment.

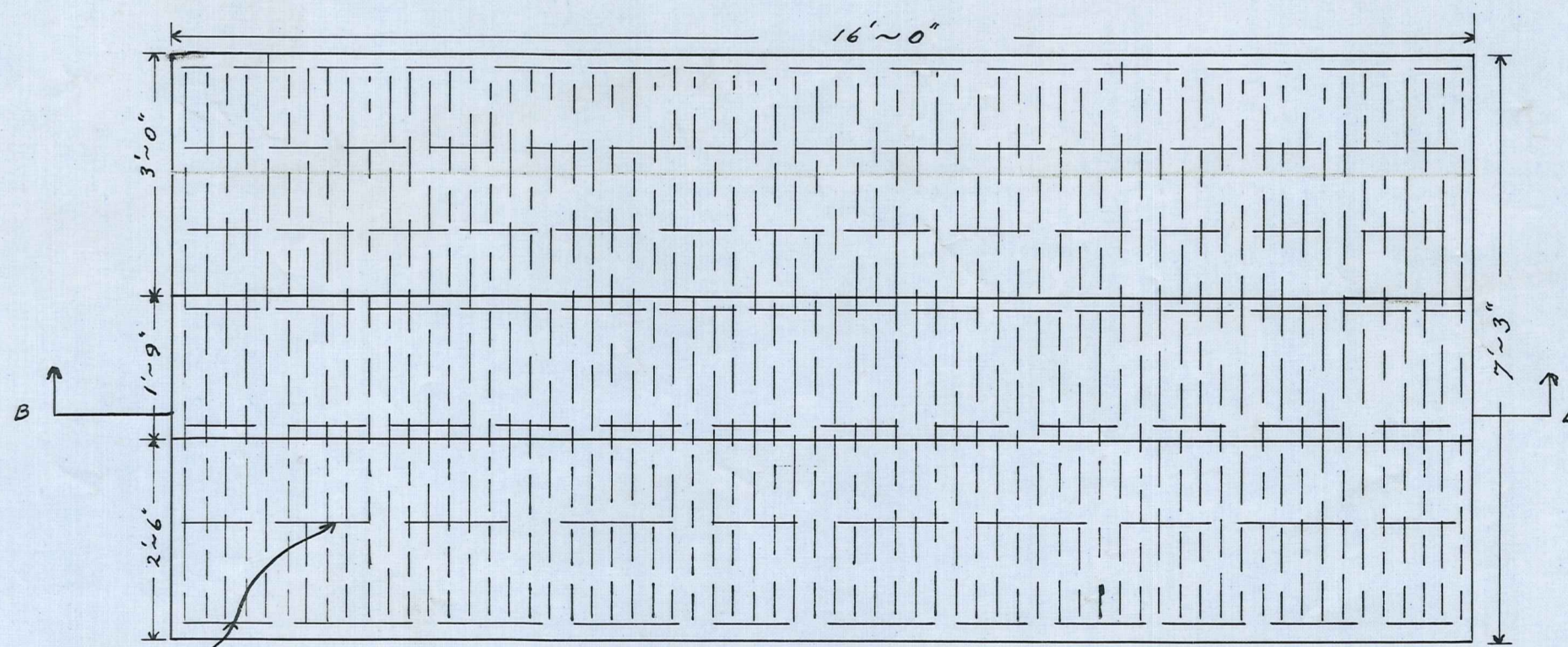

PLAN OF FOOTING SHOWING HEEL REINFORCING.

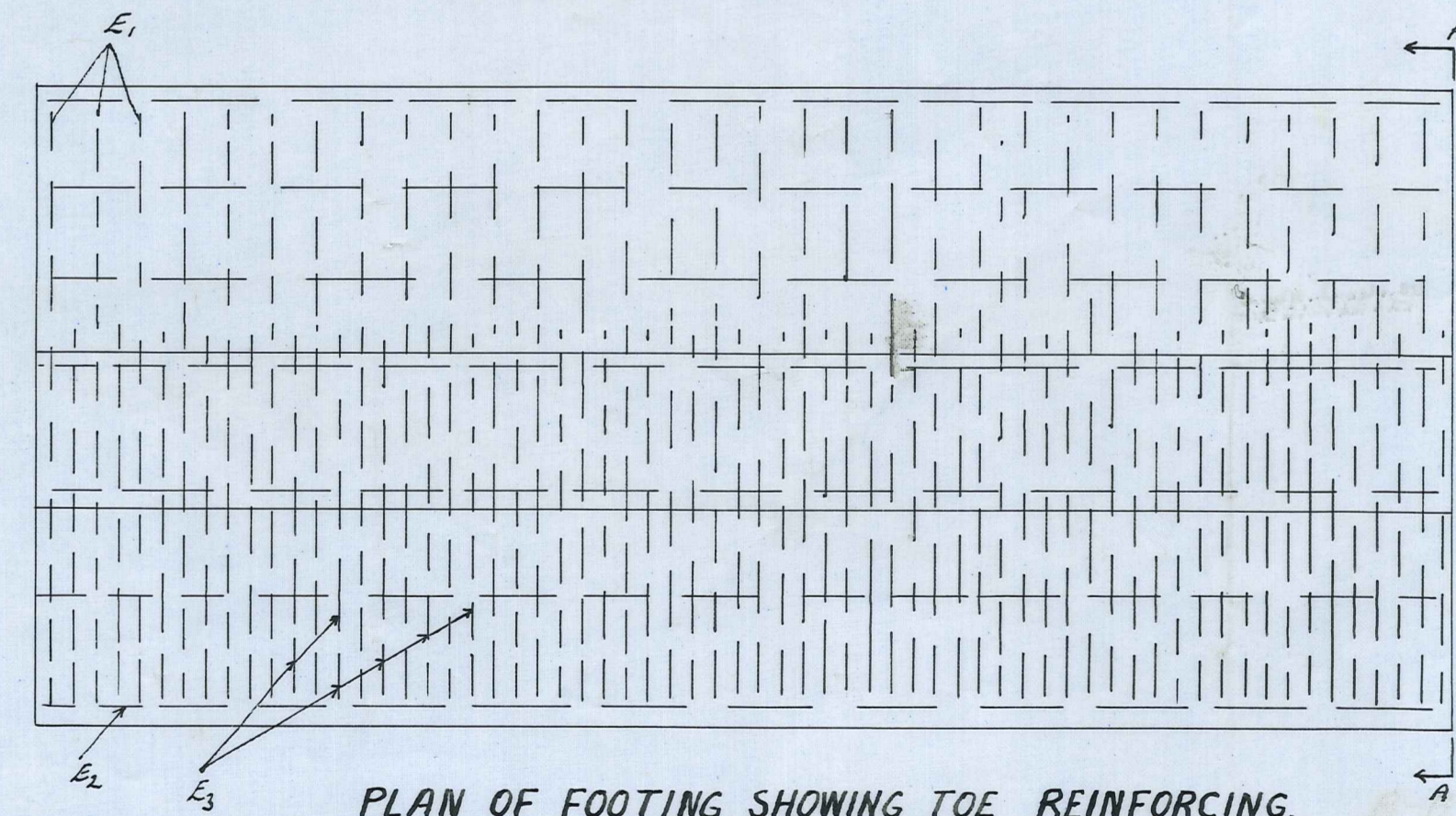

PLAN OF FOOTING SHOWING TOE REINFORCING.

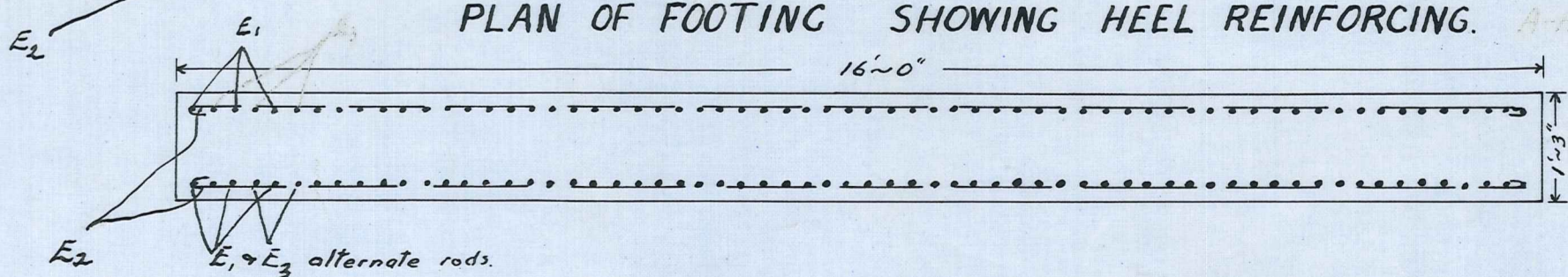

FOOTING SECTION B-B

	Name	Date
Surveyed	P.A. Evans	10/60
Drawn	"	10/60
Designed	"	10/60
Computations	"	11/60

STEEL SCHEDULE.

Rod.	Diam.	Type	No. of	Cut Length	a	b
A ₁	1/2"	I	4	14'-5"	13'-8"	
A ₂	1/2"	I	8	13'-11"	13'-2"	
A ₃	1/2"	I	8	13'-6"	12'-9"	
A ₄	1/2"	I	8	12'-11"	12'-2"	
A ₅	1/2"	I	8	12'-6"	11'-9"	
A ₆	1/2"	I	8	12'-5"	11'-8"	
W ₁	3/4"	III	24	8'-2"	6'-0"	1'-0"
W ₂	5/8"	III	36	8'-0"	6'-0"	1'-0"
W ₃	1/2"	III	56	7'-9"	6'-0"	1'-0"
W ₄	1/2"	IV	4	5'-9"	3'-0"	2'-0"
W ₅	1/2"	IV	4	4'-9"	2'-0"	2'-0"
W ₆	1/2"	II	52	7'-6"	4'-9"	2'-0"
B ₁	3/4"	I	96	7'-0"	5'-10"	
B ₂	5/8"	I	32	6'-0"	5'-0"	
B ₃	5/8"	I	34	11'-10"	10'-10"	
C ₁	1/2"	I	34	6'-7"	5'-10"	
C ₂	1/2"	I	34	11'-3"	10'-6"	
D ₁	1/2"	I	28	19'-5"	18'-8"	
D ₂	1/2"	I	28	16'-5"	15'-8"	
D ₃	1/2"	I	4	18'-1"	17'-4"	
E ₁	1/2"	I	192	7'-6"	6'-9"	
E ₂	1/2"	I	28	16'-3"	15'-6"	
E ₃	1/2"	I	64	6'-4"	4'-10"	

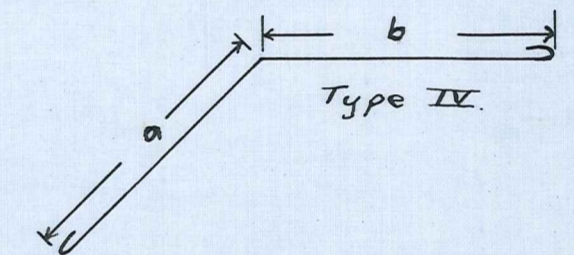
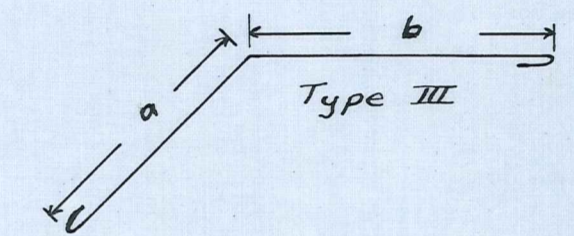
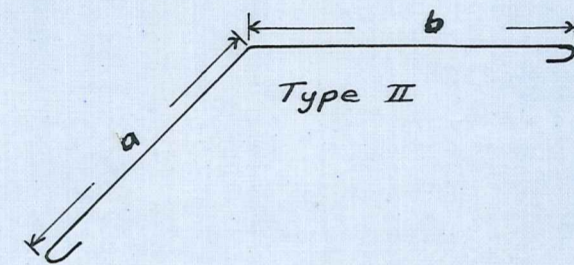
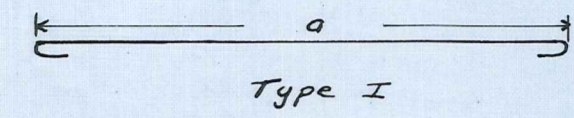

VINCENT COUNTY COUNCIL

RUTHERFORDS BRIDGE

	Name	Date
Surveyed by	D. A. Evans	10/60
Drawn "	"	10/60
Designed "	"	11/60
Completed "	"	11/60

241/8

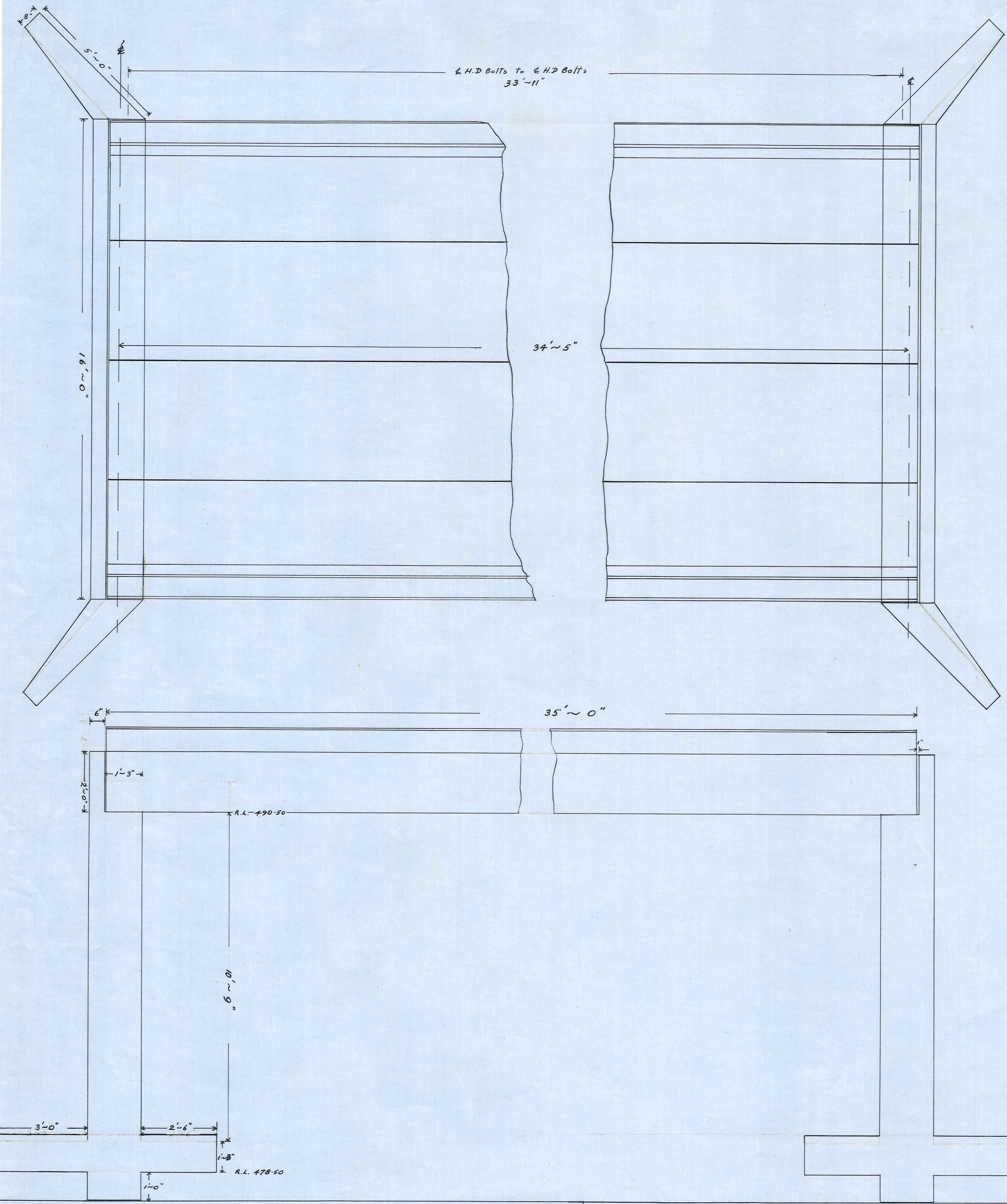

VINCENT COUNTY COUNCIL

RUTHERFORD S BRIDGE

	Name	Date
Surveyed	P. A. Evans	10/60
Drawn	"	10/60
Designed	"	11/60
Computations	"	11/60

241 / 8

Boothorn Stream

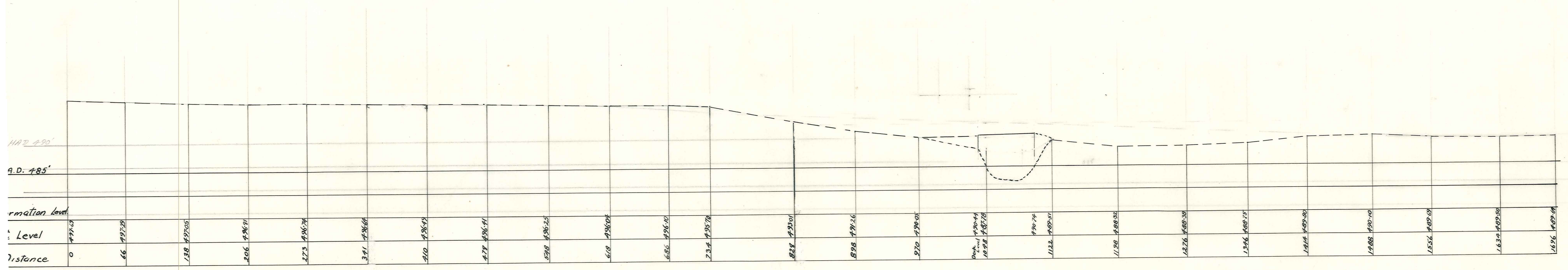

1182 450'
 9.D. 485'
 datum level
 Level
 Distance

0	66	138	206	273	341	410	477	548	618	686	754	821	898	970	1038	1103	1178	1276	1356	1414	1488	1556	1634	1696
---	----	-----	-----	-----	-----	-----	-----	-----	-----	-----	-----	-----	-----	-----	------	------	------	------	------	------	------	------	------	------

RUTHERFORDS ROAD BRIDGE