

OTAGO LAND DISTRICT MANIATOTO COUNTY

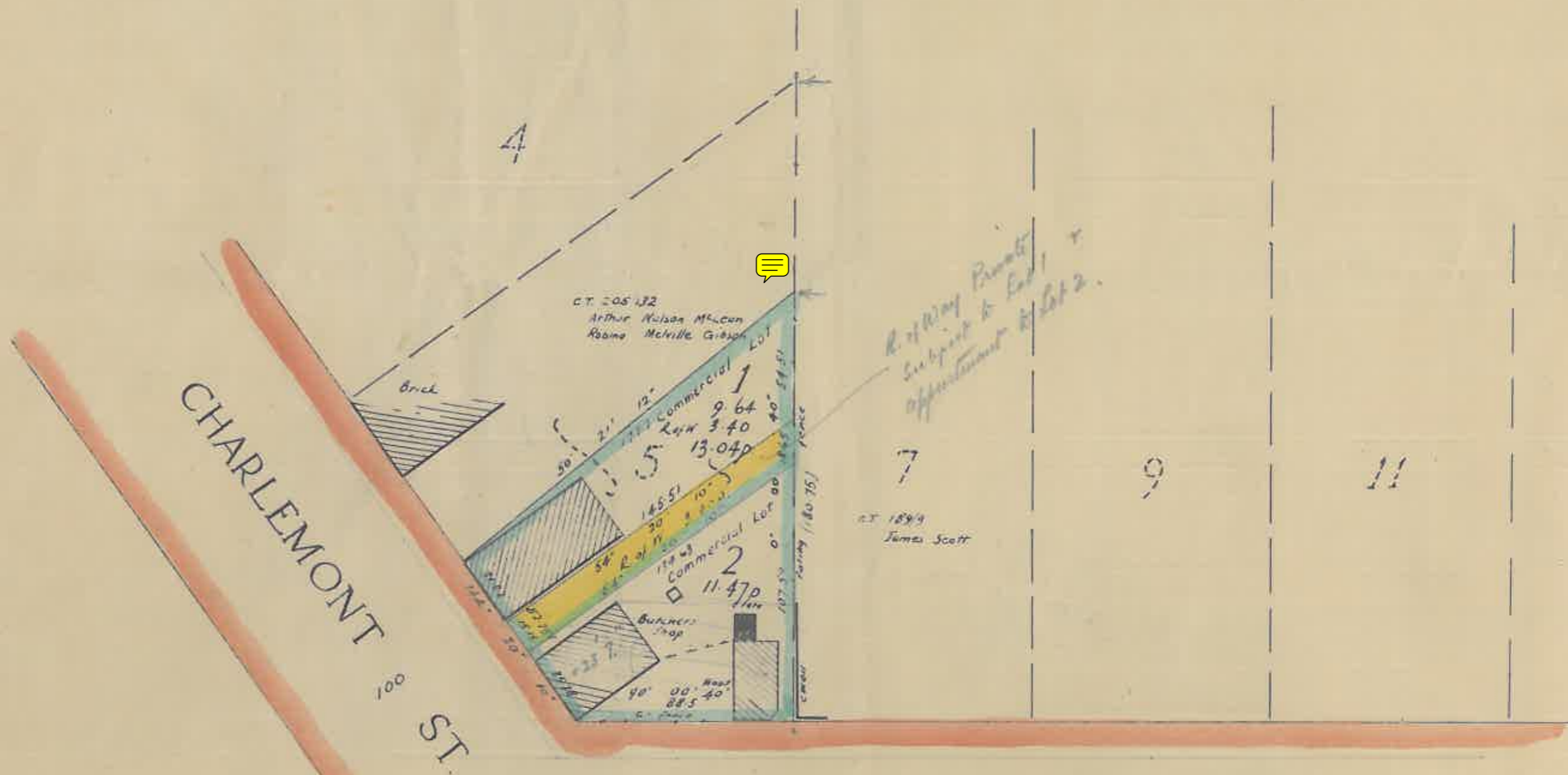

Total Area 24.51p.

JOHN ST.

150

EAST

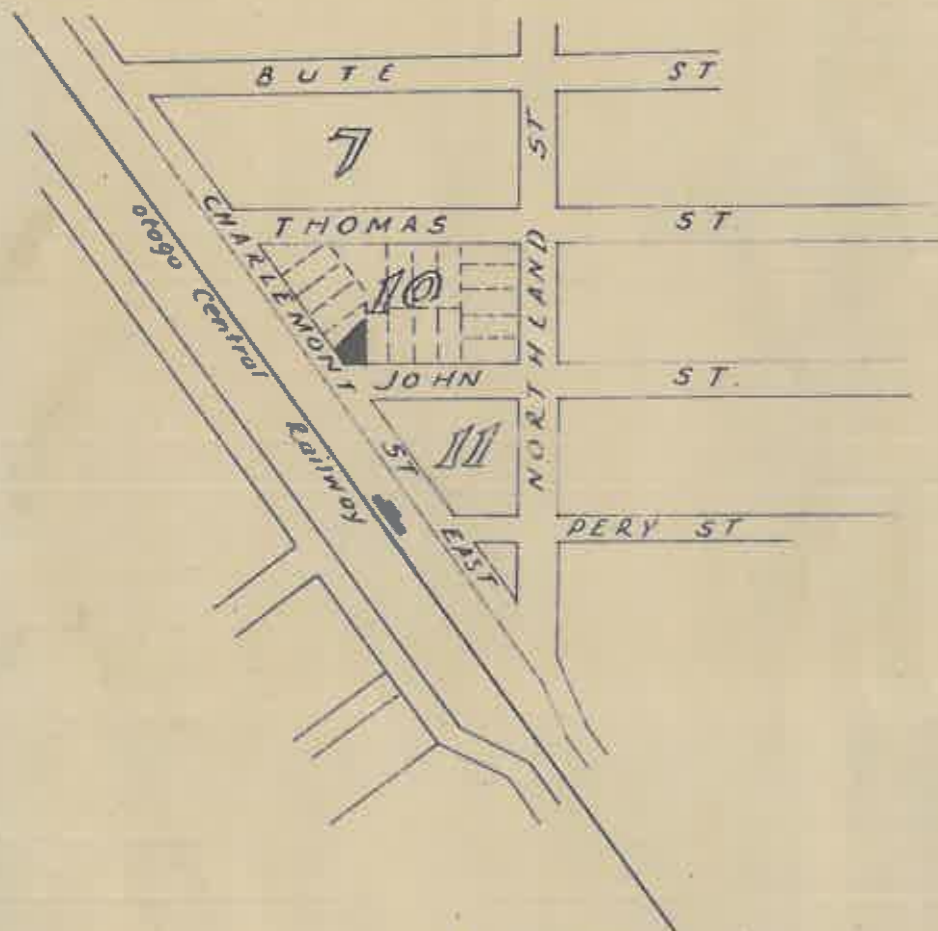

Scale: 8 chs to an inch

I hereby certify that this scheme plan has been approved in accordance with Section 3(1) of the Land Subdivision in Counties Act, 1945.

Date 18/5/1949. *H. Russell* Chief Surveyor

TOWN OF RANFURLY EXTN. NO. 12

C.T. 147/96

Proposed subdivision of part of Section 5 Block X,

TOWN OF RANFURLY

Scale: 50 links to an inch

42

386

NDR Russell, Reg Surveyor

1949