

DOCUMENT TRANSFER RECORD

ISSUED TO:

CODC
Alex.
Attn: Alan B...



TITLE/PROJECT:

As built drwgs Cromwell

Your Ref:

Our Ref:

Date:

28/10/03

- Prints Sketches Transparencies Drawings Text
 Reports Specifications Calculations

ITEM DESCRIPTION (state quantity, reference No. and description of item)

<u>As built drwgs (reduced) of Cromwell 22 no.</u>

Sent to you for the following reasons:

for your records. (These drawings were not previously in codc drawings cabinet).

SIGNED:

[Signature]

NAME:

Don Cook

PLEASE ACKNOWLEDGE RECEIPT OF DOCUMENTS(S) BY SIGNING BELOW AND RETURNING THIS FORM:

(please do not detach this portion from the form for return)

TO: Manager
Alexandra Office
Opus International Consultants Limited
69 Tarbert Street, PO Box 273
Alexandra, New Zealand

I acknowledge receipt of the documents listed above.

Signed: _____

Fax: +64 3 440 2401

Date: _____

Attention: _____

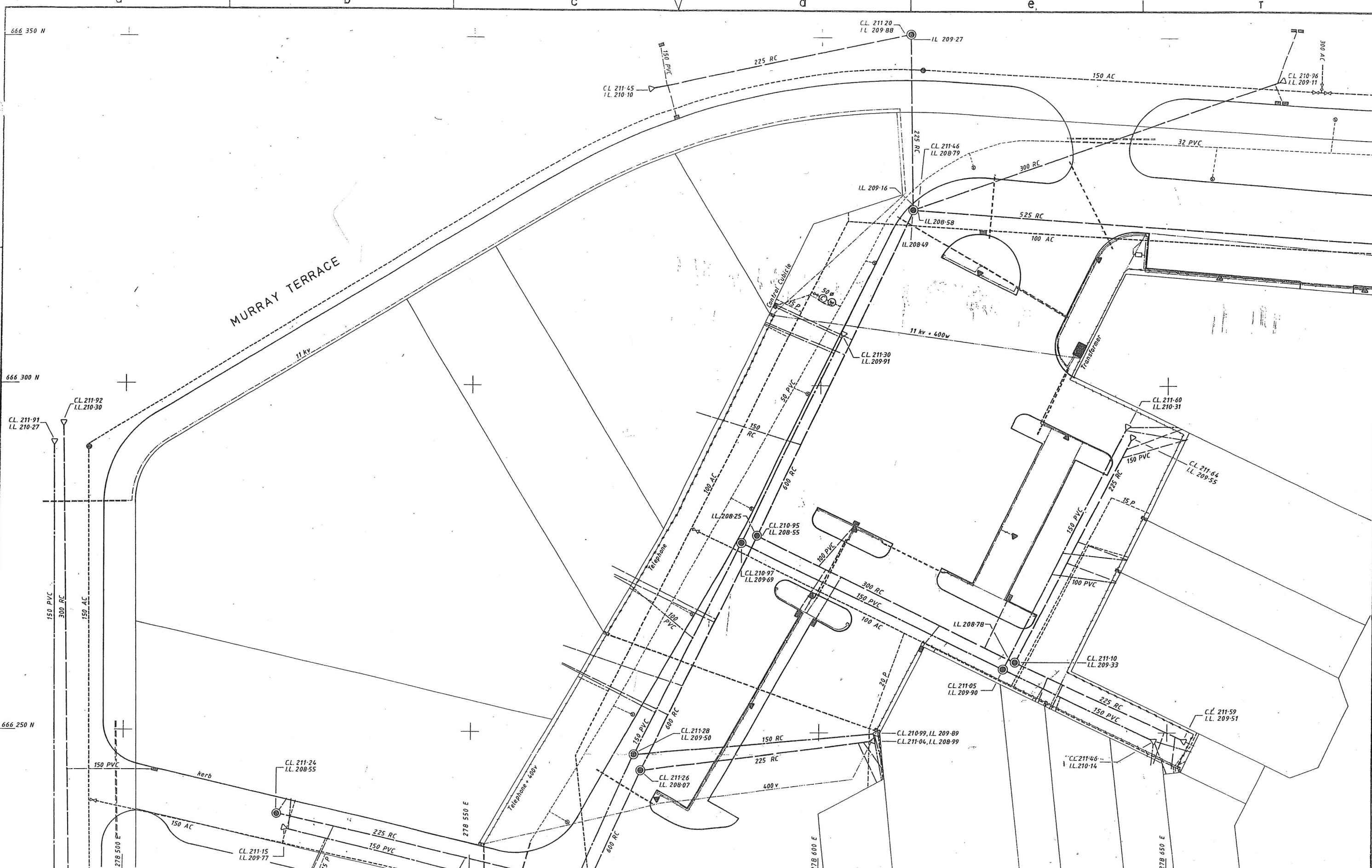

ORIGINAL SIZE
A 1

AMENDMENTS	BY	APPD.	DATE

BY	CHECKED	DATE	RECOMMENDED
drawn	M. Birles J. Meek	10-85	
APPROVED			
			E. Hughes, Project Engineer

Ministry of Works and Development

POWER
M. J. WILLIAMS
CHIEF POWER ENGINEER

T. G. SHADWELL Commissioner

CLUTHA VALLEY DEVELOPMENT

CROMWELL EXPANSION

TOWN CENTRE

'AS BUILT' SERVICES - SHEET A

ORIGINAL SCALES 1:250

JOB	CODE	SHEET	REVISION
8/1290/56	7834	100	

FILE

A	B
C	D

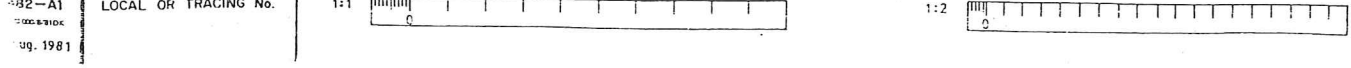

Whole numbers = mm
Decimalised expressions = m
unless indicated otherwise

CR/AB/589

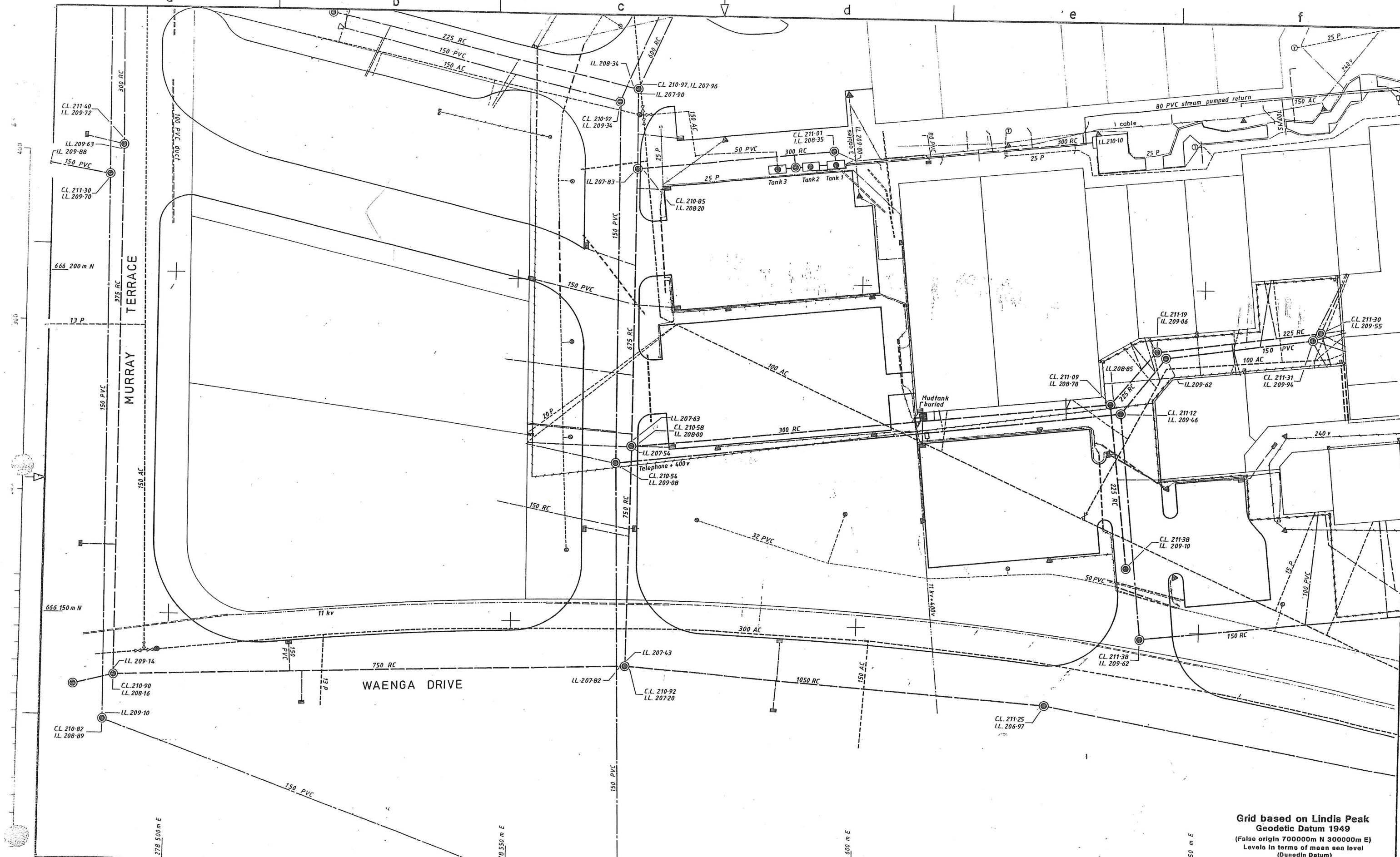

Grid based on Lindis Peak
Geodetic Datum 1949
(False origin 700000m N 300000m E)
Levels in terms of mean sea level
(Dunedin Datum)

AMENDMENTS	BY	APPD.	DATE

BY M. Birrell J. Meek	CHECKED	DATE 10-85	RECOMMENDED
APPROVED			E. Hughes, Project Engineer

Ministry of Works
and Development

POWER
M. J. WILLIAMS
CHIEF POWER ENGINEER

T. G. SHADWELL Commissioner

CLUTHA VALLEY DEVELOPMENT
CROMWELL EXPANSION
TOWN CENTRE
'AS BUILT' SERVICES - SHEET C

ORIGINAL SCALES	1:250	FILE	A B C D
JOB	8/1290/56	CODE	7834
SHEET	102	REVISION	

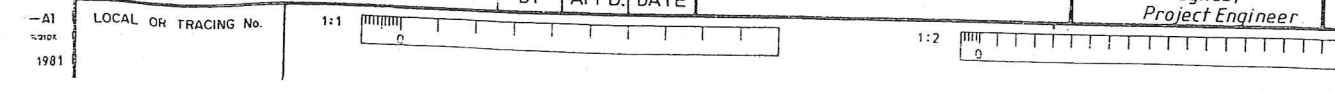

CR/AB/591

Whole numbers = mm
Decimalised expressions = m

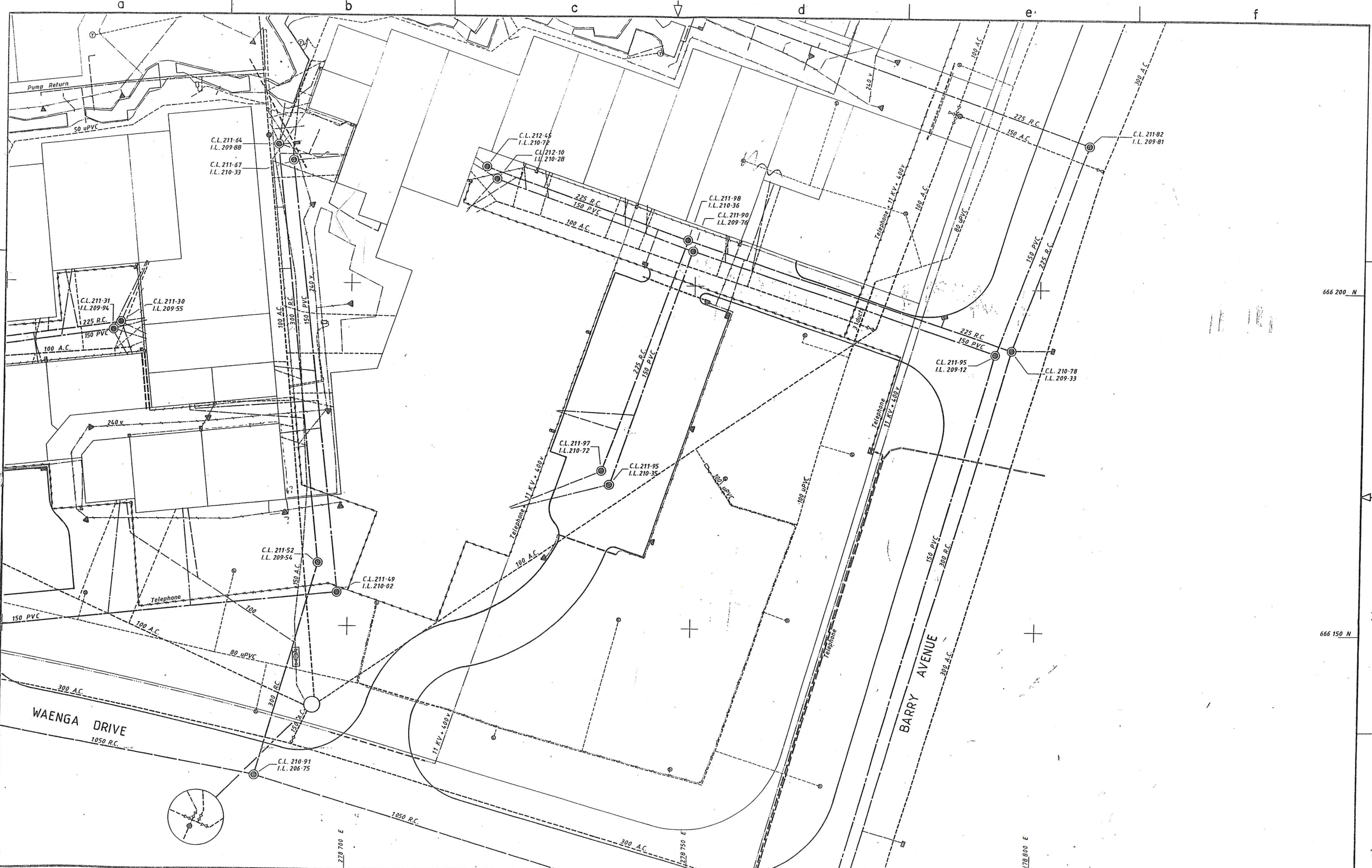

AMENDMENTS	BY	CHECKED	DATE	RECOMMENDED
	BY	APPD.	DATE	APPROVED
				E. Hughes, Project Engineer

Ministry of Works and Development

POWER
M. J. WILLIAMS
CHIEF POWER ENGINEER

T. G. SHADWELL Commissioner

CLUTHA VALLEY DEVELOPMENT

CROMWELL EXPANSION TOWN CENTRE

'AS BUILT' SERVICES - SHEET D

ORIGINAL SCALES	1:250	FILE	
JOB	CODE	SHEET	REVISION
8/1290/56	7834	103	

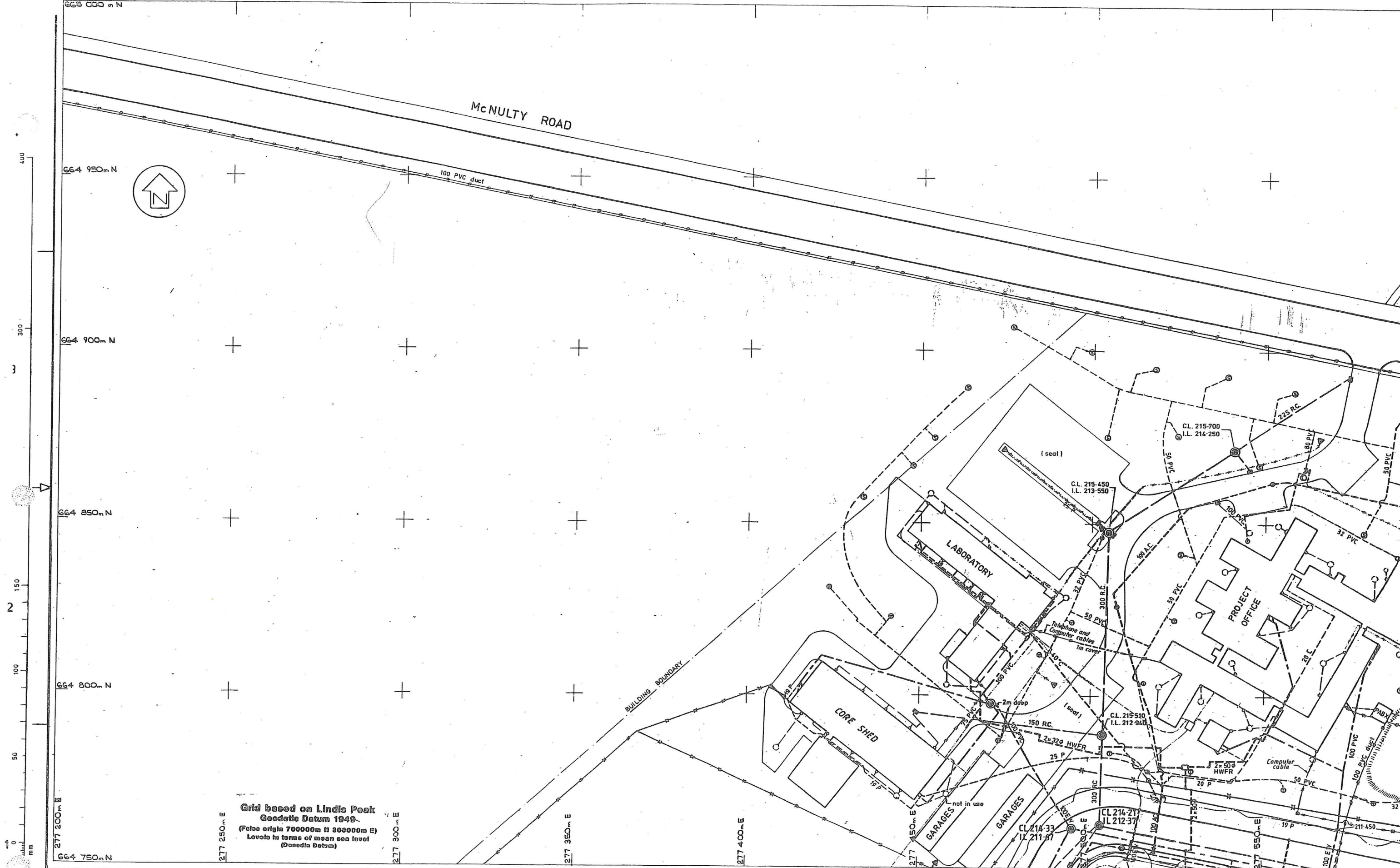

Grid based on Lindie Peak
Geodetic Datum 1940
(False origin 700000m E 3000000m N)
Levels in terms of mean sea level
(Dunedin Datum)

BY	CHECKED	DATE	RECOMMENDED
drawn <i>Amel</i>		6-81	
		2-87	APPROVED
AMENDMENTS	BY	APPD. DATE	PROJECT ENGINEER

Ministry of Works
and Development

POWER
H. W. ROBERTSON
CHIEF POWER ENGINEER

N.C. McLEOD
Commissioner

CLUTHA VALLEY DEVELOPMENT
CROMWELL EXPANSION
AREA 13-4: "AS BUILT" SERVICES

ORIGINAL SCALES	1:500	FILE
JOB	CODE	SHEET
		REVISION

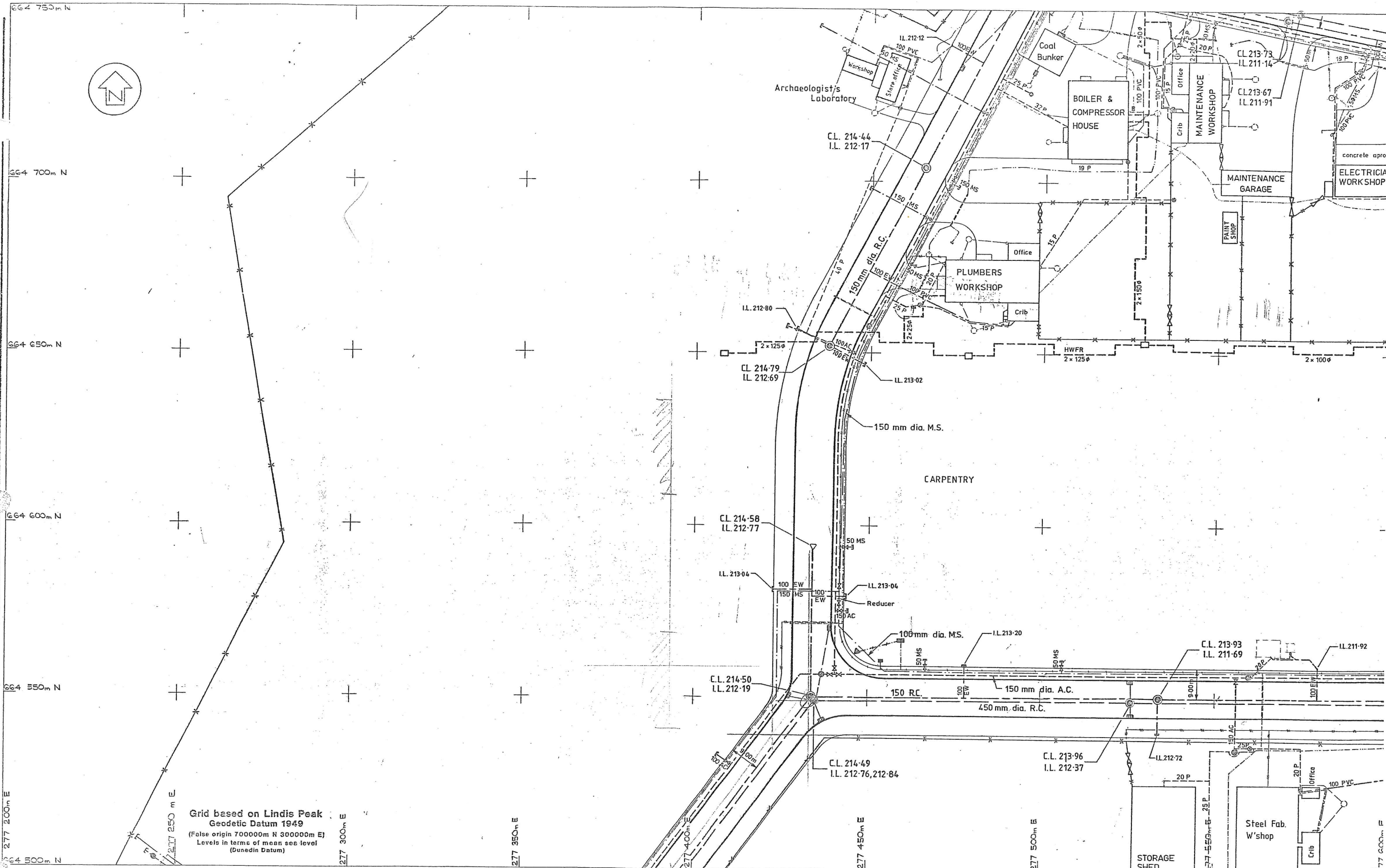

Grid based on Lindis Peak
Geodetic Datum 1949
(False origin 700000m N 300000m E)
Levels in terms of mean sea level
(Dunedin Datum)

BY	CHECKED	DATE	RECOMMENDED
drawn <i>Thelk.</i>		24.8.81	
BY	APPD.	DATE	APPROVED
AMENDMENTS	BY	APPD.	DATE
PROJECT ENGINEER			

Ministry of Works
and Development

POWER
H. W. ROBERTSON
CHIEF POWER ENGINEER

N.C. McLEOD
Commissioner

CLUTHA VALLEY DEVELOPMENT
CROMWELL EXPANSION
AREA 13-8: "AS BUILT" SERVICES

ORIGINAL SCALES	1:500	FILE
JOB	CODE	SHEET
		REVISION

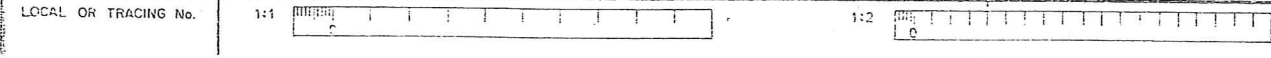

12/AG/594

Whole numbers = mm
Decimilised expressions = m

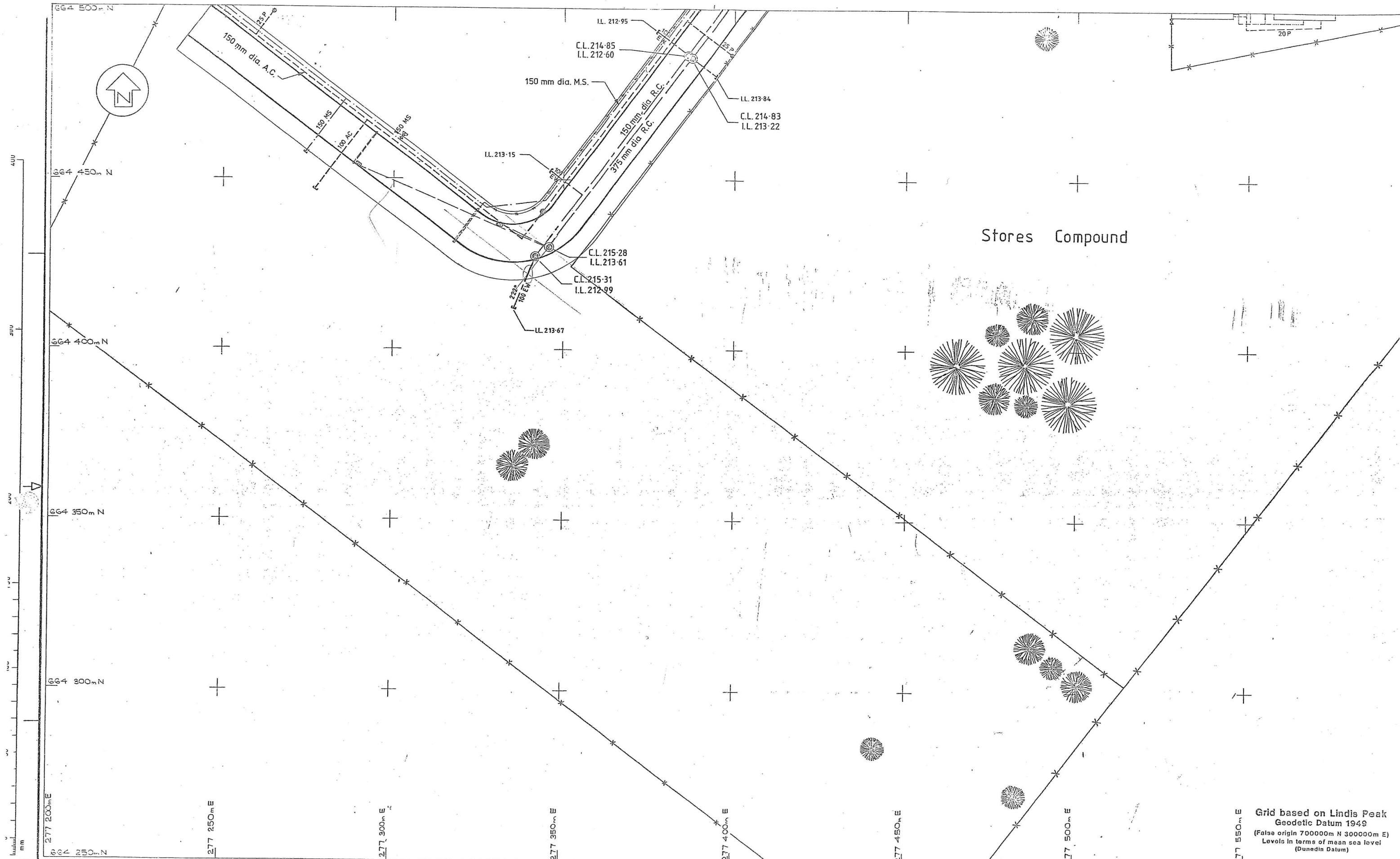

Grid based on Lindis Peak
Geodetic Datum 1949
(False origin 700000m N 300000m E)
Levels in terms of mean sea level
(Dunedin Datum)

ORIGINAL SIZE
A 1

BY	CHECKED	DATE	RECOMMENDED
drawn <i>Mick</i>		6-81	
BY	APPD.	DATE	APPROVED
AMENDMENTS			PROJECT ENGINEER

Ministry of Works
and Development

POWER
H. W. ROBERTSON
CHIEF POWER ENGINEER

N.C. McLEOD
Commissioner

CLUTHA VALLEY DEVELOPMENT
CROMWELL EXPANSION
AREA 13-12: "AS" BUILT SERVICES

ORIGINAL SCALES	1:500	FILE
JOB	CODE	SHEET
		REVISION

182-A1

LOCAL OR TRACING No.

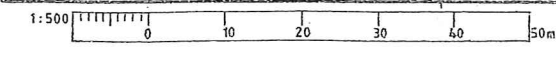
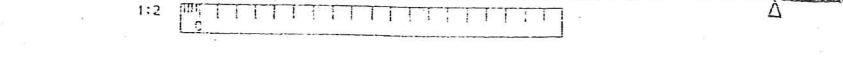
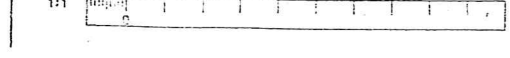

CR/BA/100

Whole numbers = mm
Decimalised expressions = m

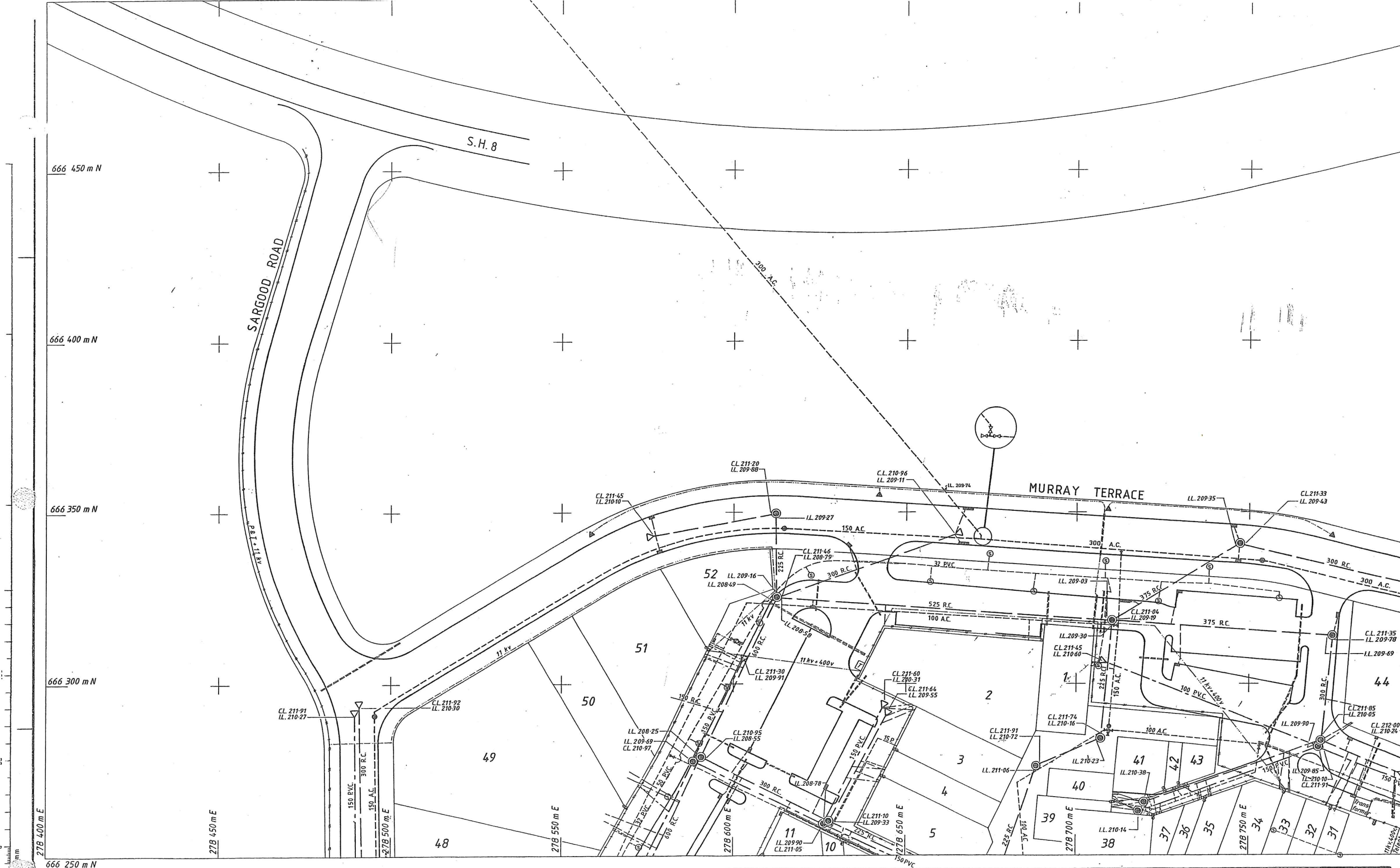

ORIGINAL SIZE A 1	BY	CHECKED	DATE	RECOMMENDED
	DRAWN <i>mech</i>		3-85	
				APPROVED
				E. Hughes Project Engineer
AMENDMENTS		BY	APPD.	DATE

Ministry of Works and Development
 POWER
 M. J. WILLIAMS
 CHIEF POWER ENGINEER
 R.G. Norman Commissioner

CLUTHA VALLEY DEVELOPMENT
CROMWELL EXPANSION
AREA 19-11 "AS BUILT" SERVICES

ORIGINAL SCALES	1:500	FILE	19-11
JOB	CODE	SHEET	REVISION

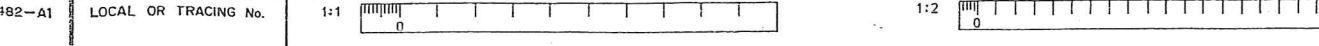

22/AB/596

Whole numbers = mm
 Decimalised expressions = m
 unless indicated otherwise



AMENDMENTS	BY	APPD.	DATE	RECOMMENDED

Ministry of Works and Development

POWER
M. J. WILLIAMS
CHIEF POWER ENGINEER

E Hughes
Project Engineer

J.J. Chesterman
Commissioner

CLUTHA VALLEY DEVELOPMENT

CROMWELL EXPANSION

AREA 19-12 "AS BUILT" SERVICES

ORIGINAL SCALES	1:500	FILE	
			19-12
JOB	CODE	SHEET	REVISION



AMENDMENTS	BY	APPD.	DATE

BY	CHECKED	DATE	RECOMMENDED
drawn			
compiled			

APPROVED	PROJECT ENGINEER

Ministry of Works and Development
 POWER
 M.J. WILLIAMS
 CHIEF POWER ENGINEER
 J.J. Chesterman
 Commissioner

CLUTHA VALLEY DEVELOPMENT
 CROMWELL EXPANSION
 AREA 19-14 "AS BUILT" SERVICES

ORIGINAL SCALES	1:500	FILE
JOB	CODL	SHEET
		REVISION



BY	CHECKED	DATE	RECOMMENDED
drawn <i>Threk</i>		3-85	
APPROVED			
E. Hughes, Project Engineer			
AMENDMENTS	BY	APPD.	DATE

Ministry of Works and Development

 POWER

 M. J. WILLIAMS

 CHIEF POWER ENGINEER

 R. G. Norman

 Commissioner

CLUTHA VALLEY DEVELOPMENT			
CROMWELL EXPANSION			
AREA 19-15 "AS BUILT" SERVICES			
ORIGINAL SCALES	1:500	FILE	
JOB	CODE	SHEET	REVISION

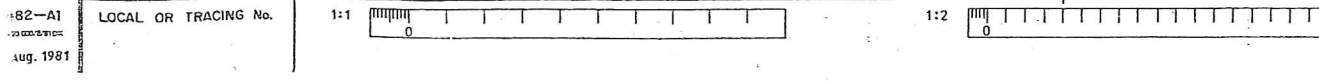

Whole numbers = mm
 Decimised expressions = m
 unless indicated otherwise

CR/AB/599

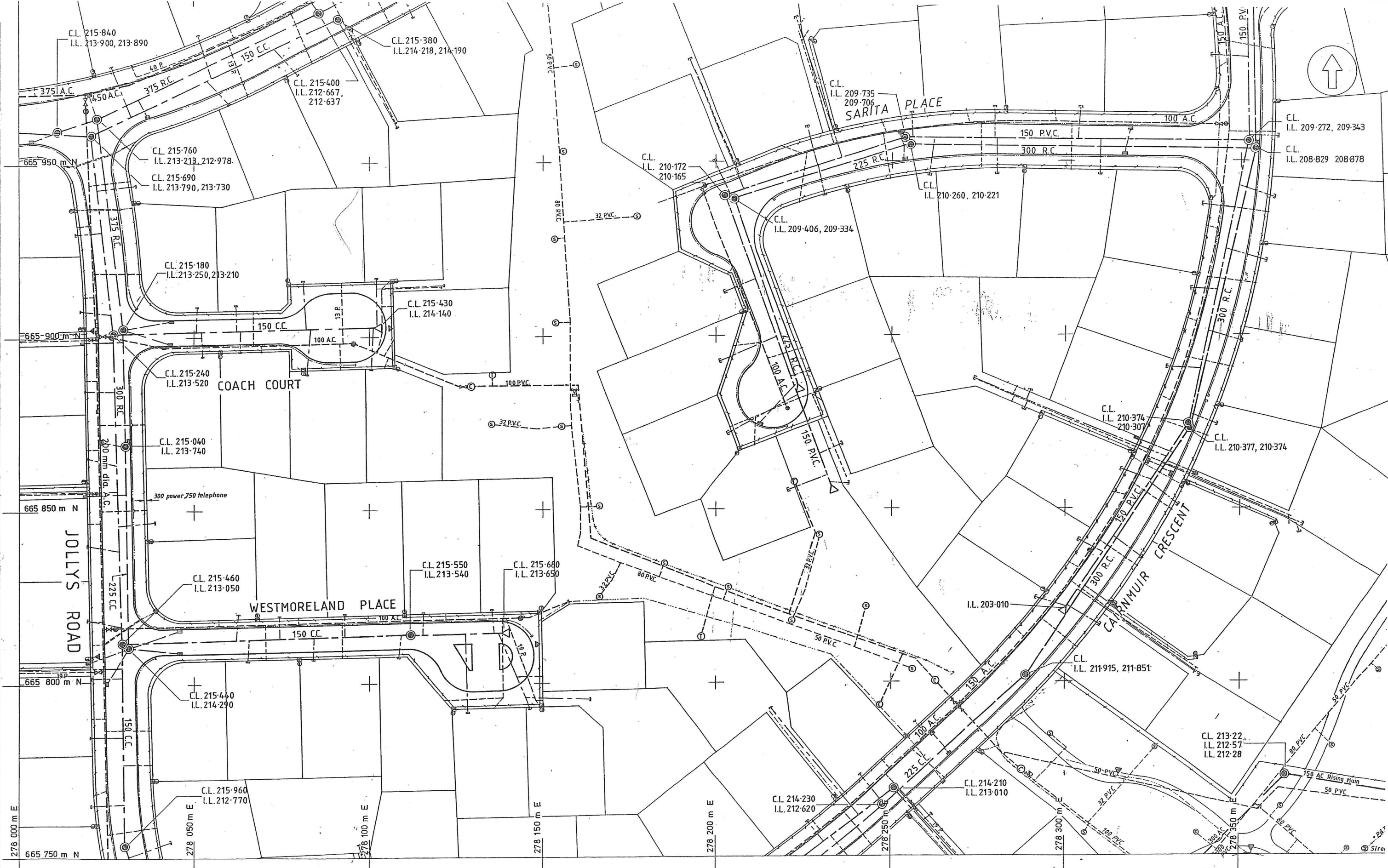

ORIGINAL SIZE
A 1

92-A1
1977

	BY	CHECKED	DATE	RECOMMENDED
	DRAWN	<i>Archie</i>	4/82	
		<i>Archie</i>	6-11-84	APPROVED
AMENDMENTS	BY	APPD.	DATE	PROJECT ENGINEER

Ministry of Works and Development
POWER
M. J. WILLIAMS
 CHIEF POWER ENGINEER
J.J. Chesterman Commissioner

CLUTHA VALLEY DEVELOPMENT
CROMWELL EXPANSION
AREA 20-2 "AS BUILT" SERVICES

ORIGINAL SCALES	1:500	FILE
JOB	CODE	SHEET
		REVISION

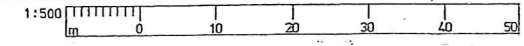
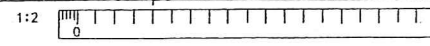
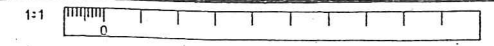

CR/AB/500

Whole numbers = mm
 Decimised expressions = m
 unless indicated otherwise

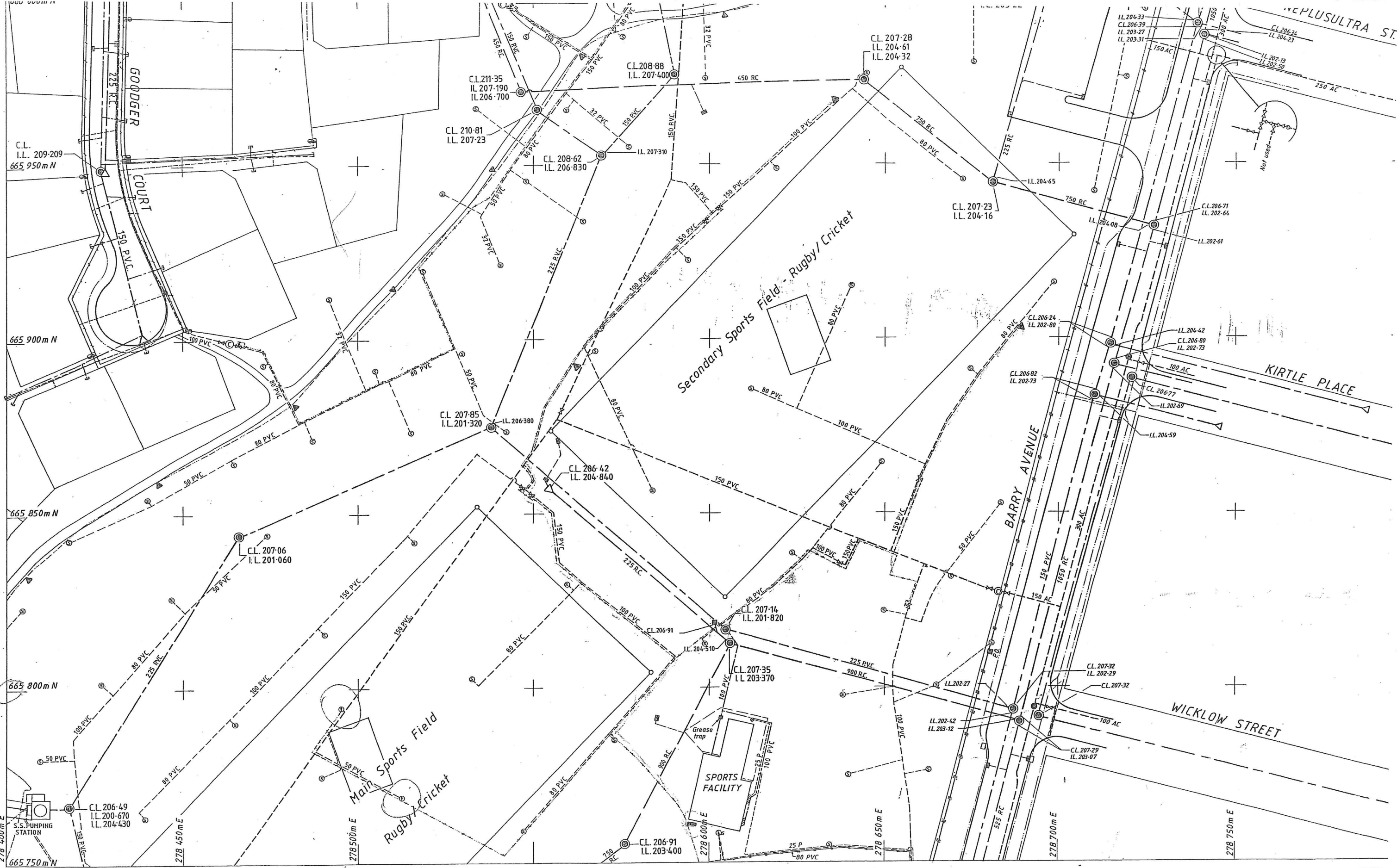

ORIGINAL SIZE
A 1

BY	CHECKED	DATE	RECOMMENDED
drawn G.B./		25/11/84	
APPROVED			
E. Hughes, Project Engineer			
AMENDMENTS	BY	APPD.	DATE

Ministry of Works and Development

POWER
M. J. WILLIAMS
CHIEF POWER ENGINEER

J. J. CHESTERMAN - Commissioner

CLUTHA VALLEY DEVELOPMENT
CROMWELL EXPANSION
AREA 20-3 "AS BUILT" SERVICES

ORIGINAL SCALES	1:500	FILE
JOB	CODE	SHEET
		REVISION

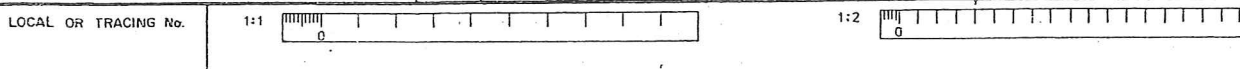

Whole numbers = mm
Decimalised expressions = m
unless indicated otherwise

CR/AB/601



Grid based on Lindis Peak
Geodetic Datum 1949
(False origin 700000m N 300000m E)
Levels in terms of mean sea level
(Dunedin Datum)

ORIGINAL SIZE A1	BY	CHECKED	DATE	RECOMMENDED	 Ministry of Works and Development POWER H. W. ROBERTSON CHIEF POWER ENGINEER N.C. McLEOD Commissioner	CLUTHA VALLEY DEVELOPMENT		ORIGINAL SCALES	1:500	FILE		
	DRAWN	<i>R.M. Jones</i>	<i>P.H. Campbell</i>	20/8/78		APPROVED	CROMWELL EXPANSION		JOB	CODE	SHEET	REVISION
	COMPILED	<i>R.D. McLean</i>	<i>B.</i>	6-7-79			AREA 20-5 "AS BUILT" SERVICES					
	SUPERVISED	<i>J. Meek</i>		25-9-78								
AMENDMENTS		BY	APPD.	DATE	FOR T. STORY PROJECT ENGINEER							
				<i>J. Meek 20/9/83</i>								

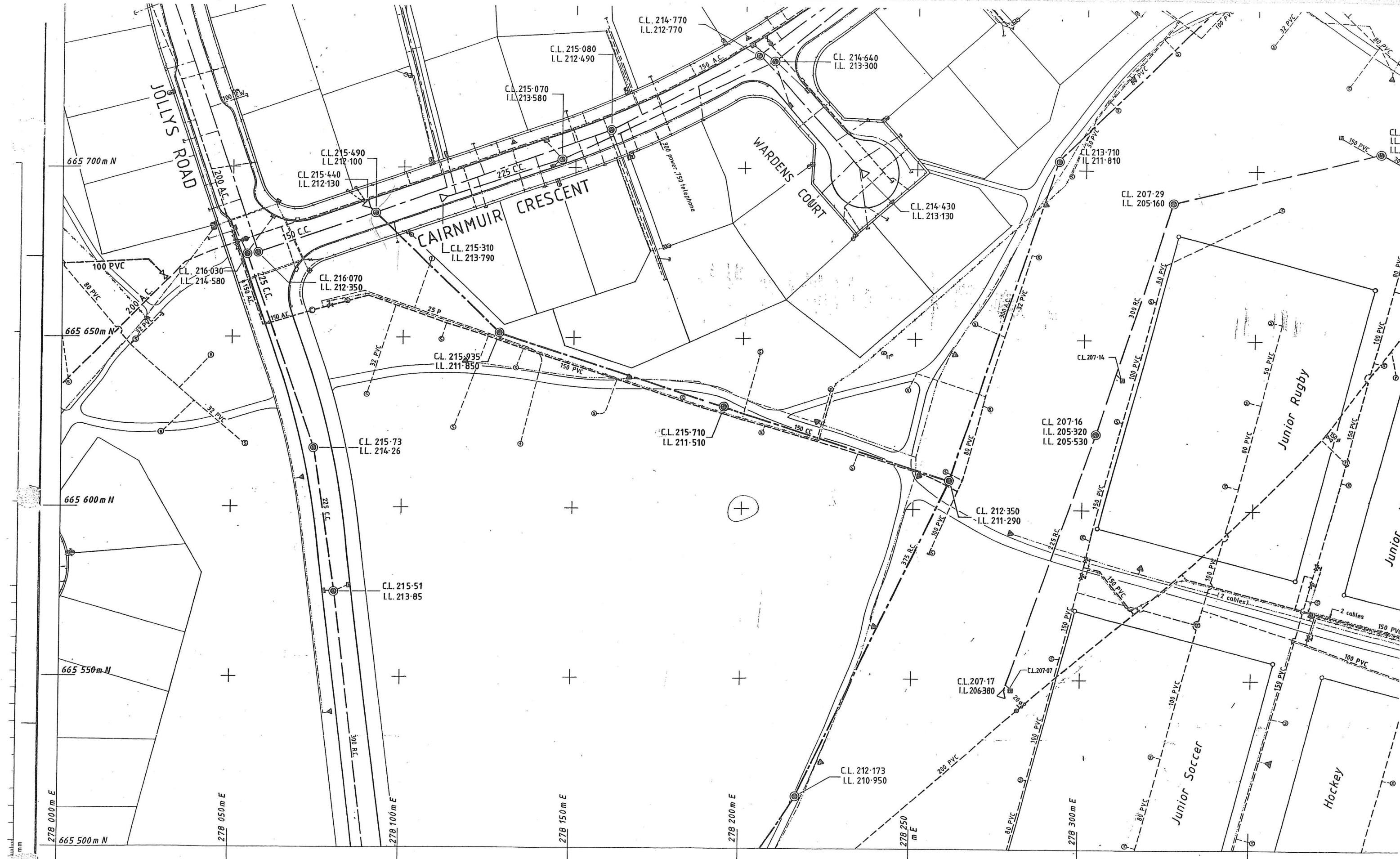

BY	CHECKED	DATE	RECOMMENDED
drawn <i>meek</i>		11-85	
AMENDMENTS			APPROVED
BY	APPD.	DATE	PROJECT ENGINEER

Ministry of Works and Development
 POWER
 M. J. WILLIAMS
 CHIEF POWER ENGINEER
 R. G. Norman
 Commissioner

CLUTHA VALLEY DEVELOPMENT
CROMWELL EXPANSION
AREA 20-6 "AS BUILT" SERVICES

ORIGINAL SCALES	1:500	FILE
JOB	CODE	SHEET
		REVISION

CR/AB/603



BY	CHECKED	DATE	RECOMMENDED
DRAWN	G.B./	21.9.84	
APPROVED			
E Hughes Project Engineer			
AMENDMENTS		BY	APPD. DATE
LOCAL OR TRACING No.		1:1	

Ministry of Works and Development
 POWER
 M. J. WILLIAMS
 CHIEF POWER ENGINEER
 R.G. Norman
 Commissioner

CLUTHA VALLEY DEVELOPMENT
CROMWELL EXPANSION
AREA 20-7 "AS BUILT" SERVICES

ORIGINAL SCALES	1:500	FILE
JOB	CODE	SHEET
		REVISION

CL/AB/16-4

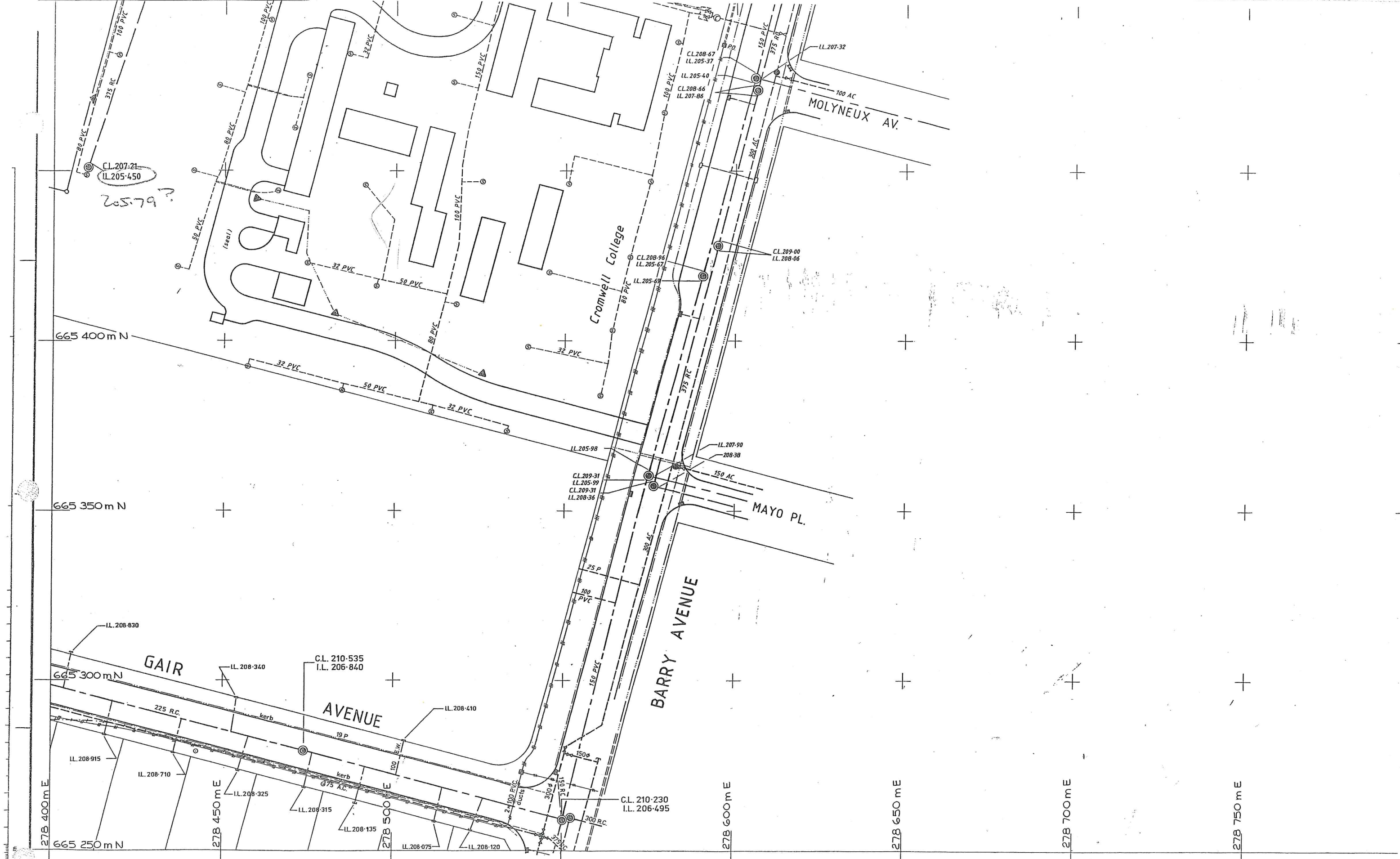

ORIGINAL SIZE A1	AMENDMENTS BY APPD. DATE				PROJECT ENGINEER	Ministry of Works and Development POWER H. W. ROBERTSON CHIEF POWER ENGINEER N.C. McLEOD Commissioner	CLUTHA VALLEY DEVELOPMENT CROMWELL EXPANSION AREA 20-11 : "AS BUILT" SERVICES		ORIGINAL SCALES 1:500	FILE
	LOCAL OR TRACING No.	1:1	1:2	1:500	0 10 20 30 40 50 m		JOB	CODE	SHEET	REVISION

Whole numbers = mm
 Decimalised expressions = m

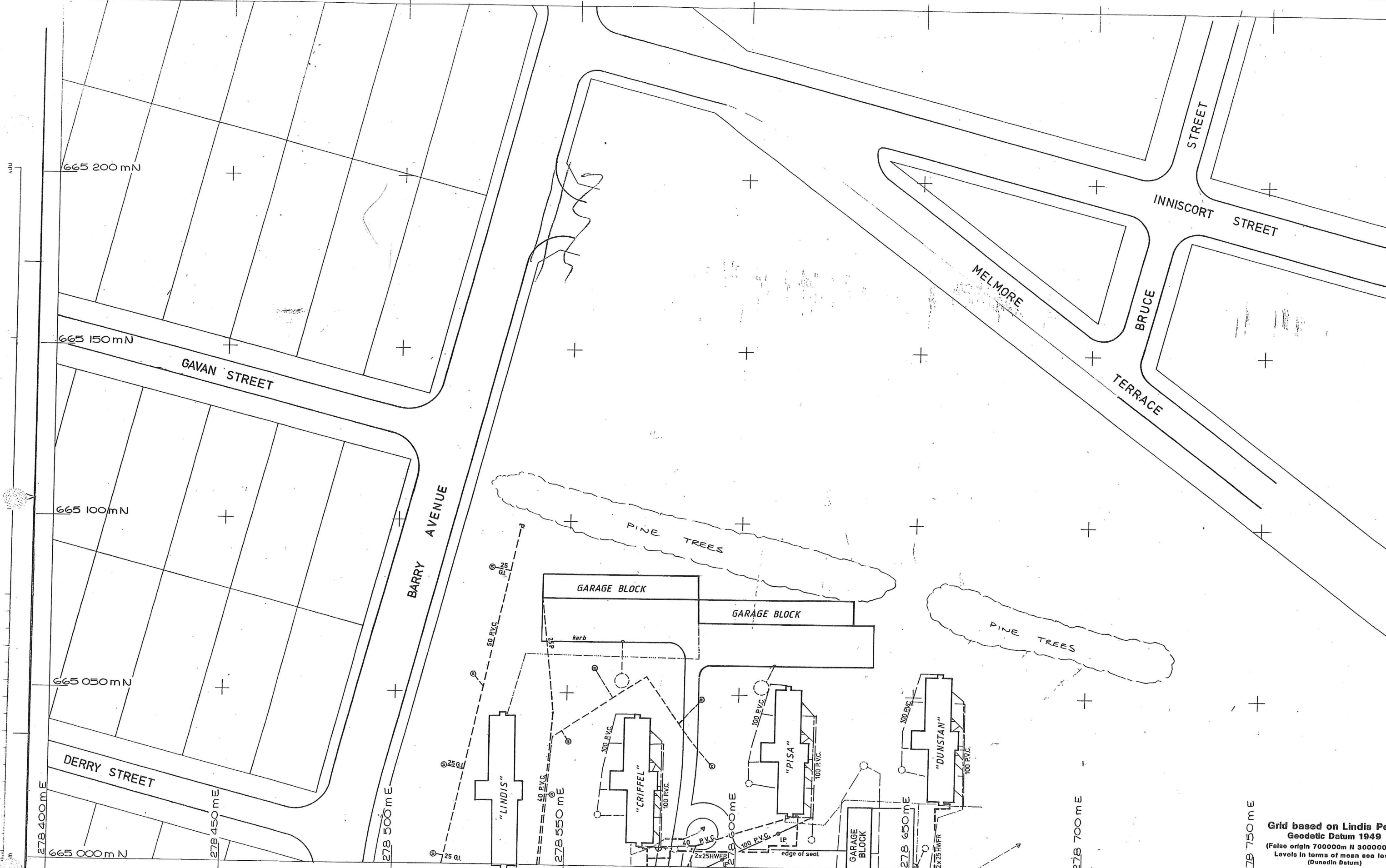

Grid based on Lindis Peak
Geodetic Datum 1949
(False origin 700000m N 300000m E
Levels in terms of mean sea level
(Dunedin Datum))

DRAWN		BY	CHECKED	DATE	RECOMMENDED	 Ministry of Works and Development POWER H. W. ROBERTSON CHIEF POWER ENGINEER N.C. McLEOD Commissioner	CLUTHA VALLEY DEVELOPMENT CROMWELL EXPANSION AREA 20-15: "AS BUILT" SERVICES		ORIGINAL SCALES	1:500	FILE
COMPILED					APPROVED				JOB	CODE	SHEET
AMENDMENTS		BY	APPD.	DATE	FOR T STORY PROJECT ENGINEER						

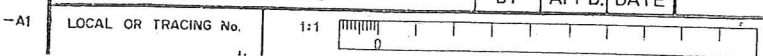

A1

-A1

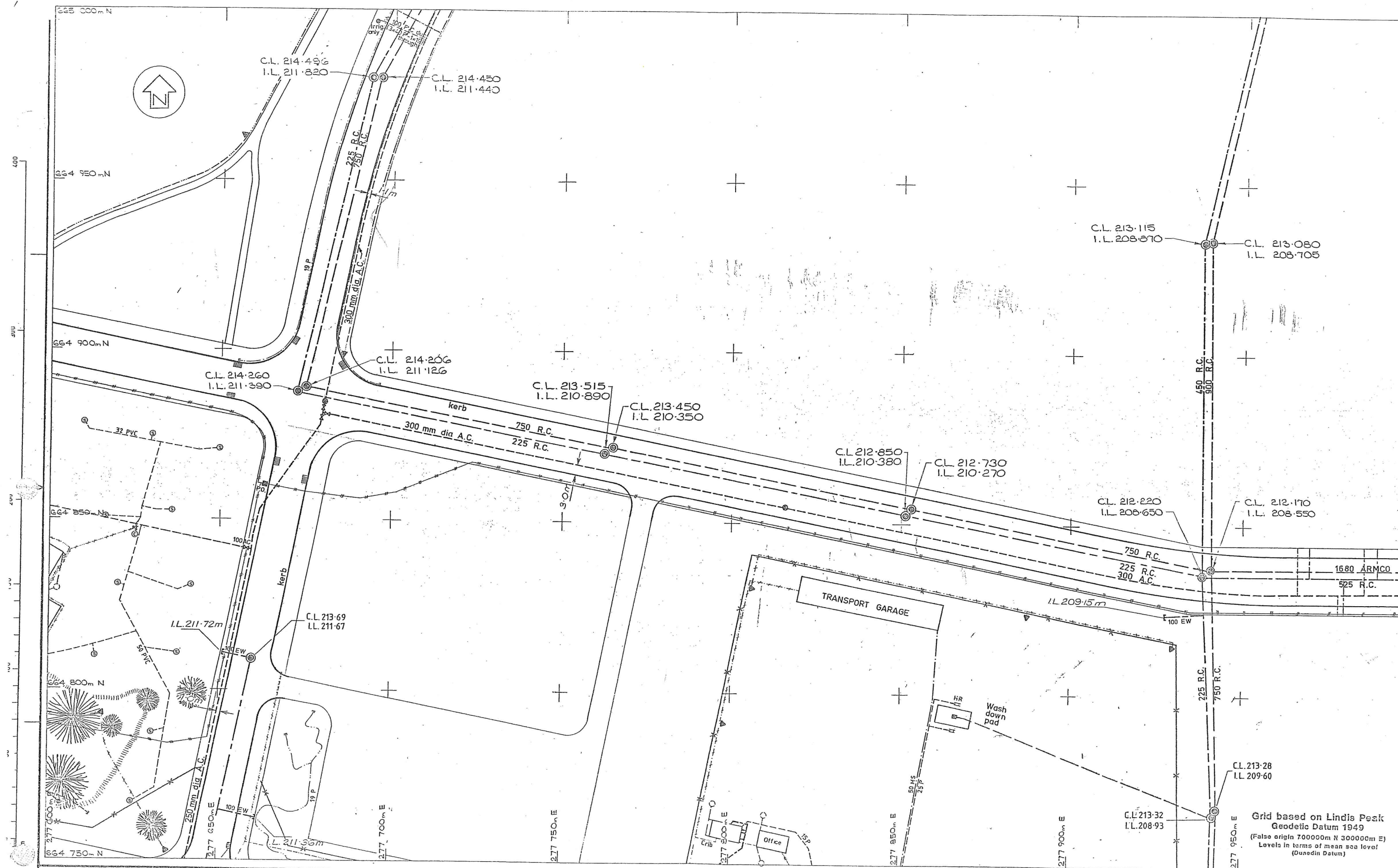

Grid based on Lindis Peak
Geodetic Datum 1949
(False origin 700000m N 300000m E)
Levels in terms of mean sea level
(Dunedin Datum)

BY	CHECKED	DATE	RECOMMENDED
drown		13 6 78	
		14 6 78	
			APPROVED
			FOR T. STONY PROJECT ENGINEER

AMENDMENTS	BY	APPD.	DATE

Ministry of Works
and Development

POWER
H. W. ROBERTSON
CHIEF POWER ENGINEER

N.C. McLEOD
Commissioner

CLUTHA VALLEY DEVELOPMENT
CROMWELL EXPANSION
AREA 21-1: "AS BUILT" SERVICES

ORIGINAL SCALES	1:500	FILE
JOB	CODE	SHEET
		REVISION

CL. 209-970
 I.L. 207-910

NOTE: REDUCED PRINT
 STATED SCALE INCORRECT

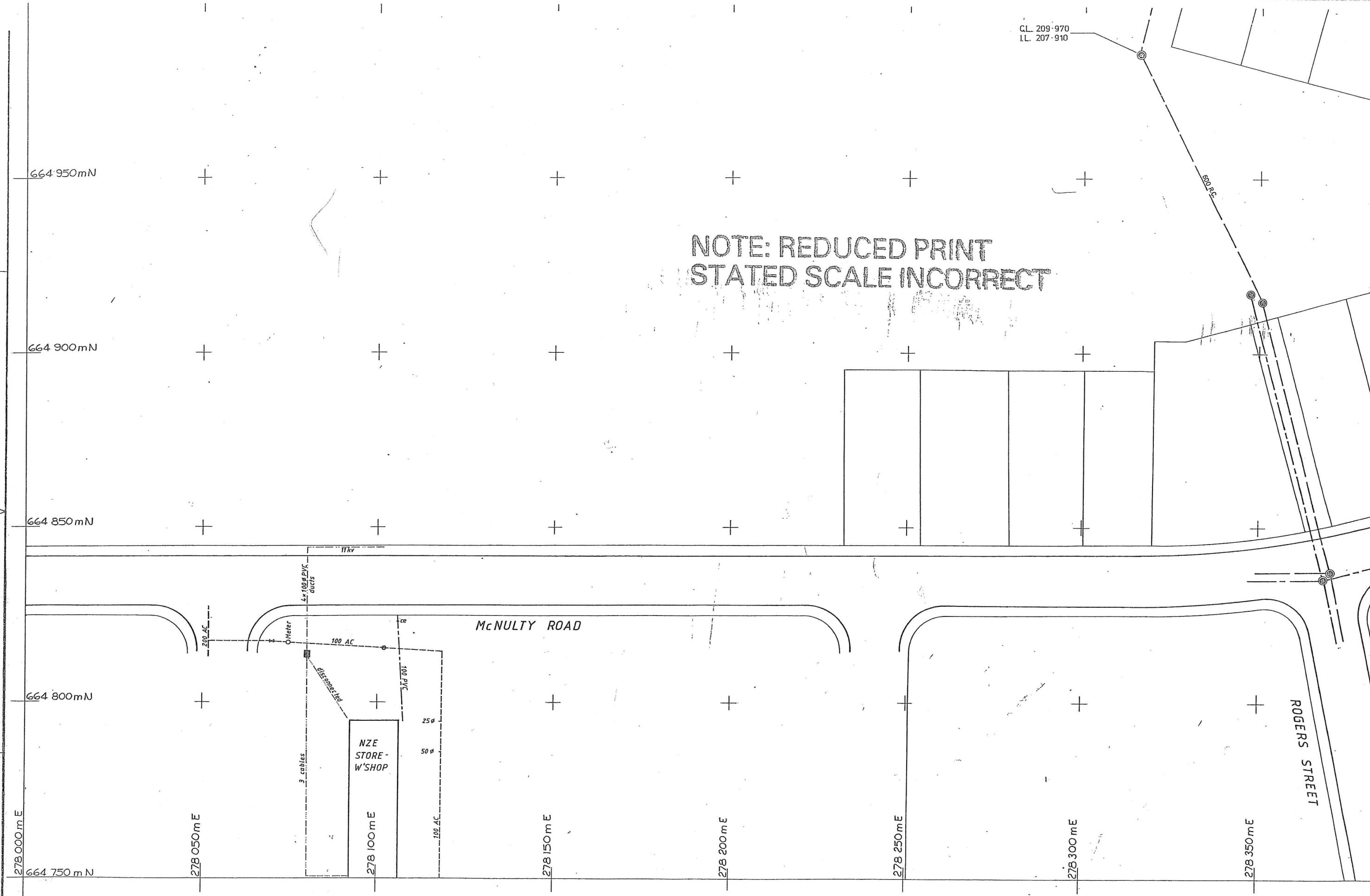

DRAWN		BY	CHECKED	DATE	RECOMMENDED	 Ministry of Works and Development POWER H. W. ROBERTSON CHIEF POWER ENGINEER N.C. McLEOD Commissioner	CLUTHA VALLEY DEVELOPMENT		ORIGINAL SCALES	1:500	FILE
COMPILED					APPROVED		CROMWELL EXPANSION		JOB	CODE	SHEET
SUP'VISED					For T STORY PROJECT ENGINEER	AREA 21-2 : "AS BUILT" SERVICES					
AMENDMENTS		BY	APPD.	DATE							

ORIGINAL SIZE
 A1

2-A1

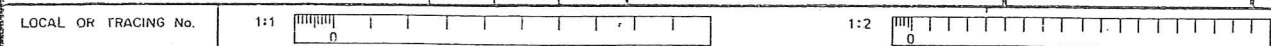

CR/AB/603

Whole numbers = mm
 Decimalised expression

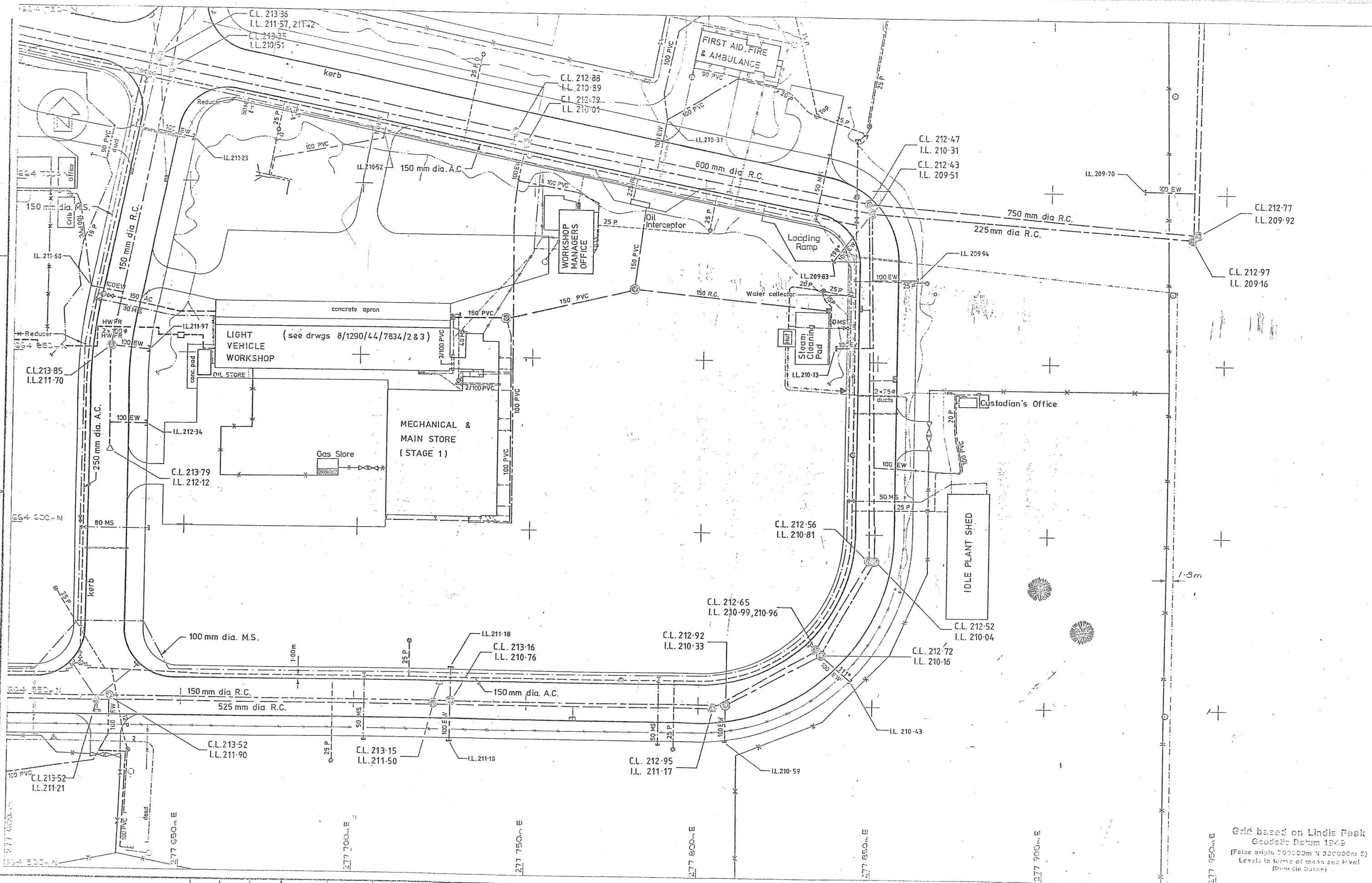

Grid based on Lindis Peak
 Geodetic Datum 1949
 (False origin 707000m N 300000m E)
 Levels in terms of mean sea level
 (Dunedin Datum)

ORIGINAL SIZE
 A1

drawn	BY <i>Jack</i>	CHECKED	DATE 6-81	RECOMMENDED
APPROVED				PROJECT ENGINEER
AMENDMENTS		BY	APPD.	DATE
LOCAL OF TRADING No.		111	1:2	

Ministry of Works
 and Development

POWER
 H. W. ROBERTSON
 CHIEF POWER ENGINEER

N.C. McLEOD
 Commissioner

CLUTHA VALLEY DEVELOPMENT
 CROMWELL EXPANSION
 AREA 21-5 : "AS BUILT" SERVICES

ORIGINAL SCALES	1:500	FILE
JOB	CODE	SHEET
REVISION		

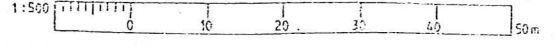

CR/AB/610

Whole number, 1 mm