

Appendix D:

Certificate of Titles





**RECORD OF TITLE
UNDER LAND TRANSFER ACT 2017
FREEHOLD**

**Guaranteed Search Copy issued under Section 60 of the Land
Transfer Act 2017**



R. W. Muir
Registrar-General
of Land

Identifier **126180**
Land Registration District **Otago**
Date Issued 05 August 2004

Prior References

OT109/201 OT7C/631

Estate Fee Simple
Area 93.0792 hectares more or less
Legal Description Lot 2 Deposited Plan 330709 and Section
4, 11, 98, 101, 103 Block III Cromwell
Survey District and Part Section 5, 25
Block III Cromwell Survey District and
Part Run 1201R

Registered Owners

New Zealand Cherry Corp (Leyser) Limited Partnership

Interests

Excepting and reserving from Sections 4 and 11 and the part Section 5 herein to Her Majesty the Queen all minerals, mineral oil, gas, metals, coal and valuable stone under the surface of the land
Subject to Section 8 Mining Act 1971 (affects Sections 98, 101 and 103 Block III Cromwell Survey District)
Subject to Section 168A Coal Mines Act 1925 (affects Sections 98, 101 and 103 Block III Cromwell Survey District)
Lot 2 on DP 330709 is subject to interests, easements and rights under the laws relating to Mining, Mines and Minerals.
Subject to Section 241(2) Resource Management Act 1991 (affects DP 330709)
Subject to a right to convey water over part Section 11 marked A DP 344529, over part Section 98 marked B DP 344529 and over part lot 2 DP 330709 marked C DP 344529 created by Easement Instrument 6264801.4 - 23.12.2004 at 9:00 am
The easements created by Easement Instrument 6264801.4 are subject to Section 243 (a) Resource Management Act 1991
Subject to a right to convey water over part marked A, B and C on DP 344529 created by Easement Instrument 7073932.4 - 17.10.2006 at 9:00 am
Subject to a right (in gross) to convey electricity over part Part Section 5 marked A, Section 103 marked B, Section 11 marked C and D and Section 98 Block III Cromwell Survey District marked E and the right to transform electricity over part Section 11 Block III Cromwell Survey District marked D on DP 524841 in favour of Aurora Energy Limited created by Easement Instrument 11175490.2 - 6.8.2018 at 7:29 am
11211780.3 Mortgage to Bank of New Zealand - 31.8.2018 at 4:12 pm

Title Diagram 126180

Copy - 01/01, Pgs - 001, 13/03/04, 15:02



DocID: 110526679

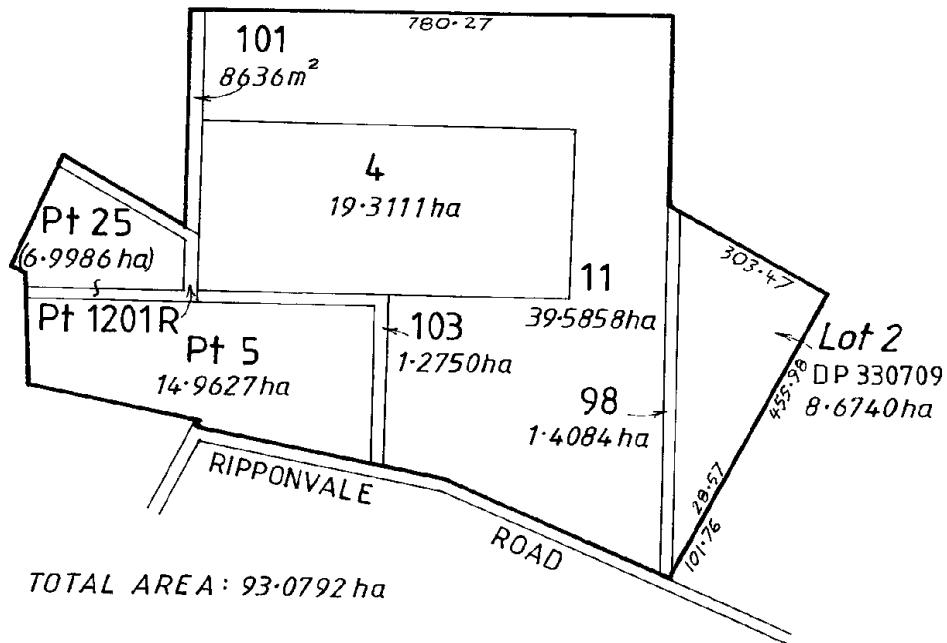



**RECORD OF TITLE
UNDER LAND TRANSFER ACT 2017
FREEHOLD**

**Guaranteed Search Copy issued under Section 60 of the Land
Transfer Act 2017**



R. W. Muir
Registrar-General
of Land

Identifier **OT7C/632**
Land Registration District **Otago**
Date Issued 12 September 1978

Prior References

OT73/239 OT7C/630

Estate Fee Simple
Area 113.0835 hectares more or less
Legal Description Section 27-28, 96, 99, 102 Block III
 Cromwell Survey District

Registered Owners

New Zealand Cherry Corp (Leyser) Limited Partnership

Interests

Sections 96, 99 and 102 are Subject to Section 8 Mining Act 1971
Sections 96, 99 and 102 are Subject to Section 168A Coal Mines Act 1925
11211780.3 Mortgage to Bank of New Zealand - 31.8.2018 at 4:12 pm

Title Diagram Title Diagr

Copy - 01/01, Pgs - 001, 07/11/07, 09:17



DocID: 119879741

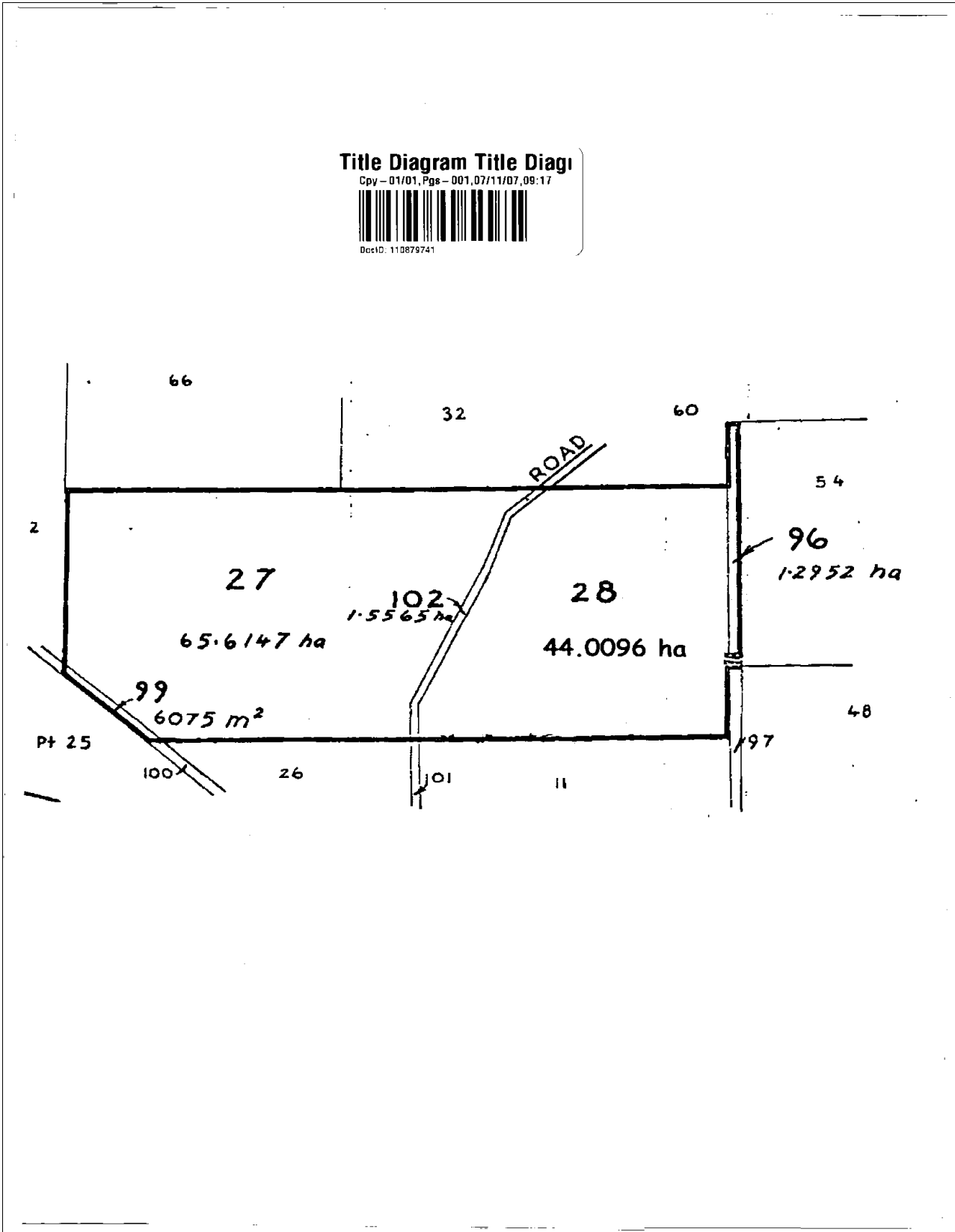



**RECORD OF TITLE
UNDER LAND TRANSFER ACT 2017
FREEHOLD**

**Guaranteed Search Copy issued under Section 60 of the Land
Transfer Act 2017**



R. W. Muir
Registrar-General
of Land

Identifier **OT7C/633**
Land Registration District **Otago**
Date Issued 12 September 1978

Prior References

OT109/200 OT7C/630

Estate Fee Simple
Area 14.7306 hectares more or less
Legal Description Section 26, 100 Block III Cromwell
 Survey District

Registered Owners

New Zealand Cherry Corp (Leyser) Limited Partnership

Interests

Section 100 is Subject to Section 8 Mining Act 1971
Section 100 is Subject to Section 168A Coal Mines Act 1925
11211780.3 Mortgage to Bank of New Zealand - 31.8.2018 at 4:12 pm

Title Diagram Title Diagram

Copy - 01/01, Pages - 001, 07/11/07, 08:18



DocID: 110879742

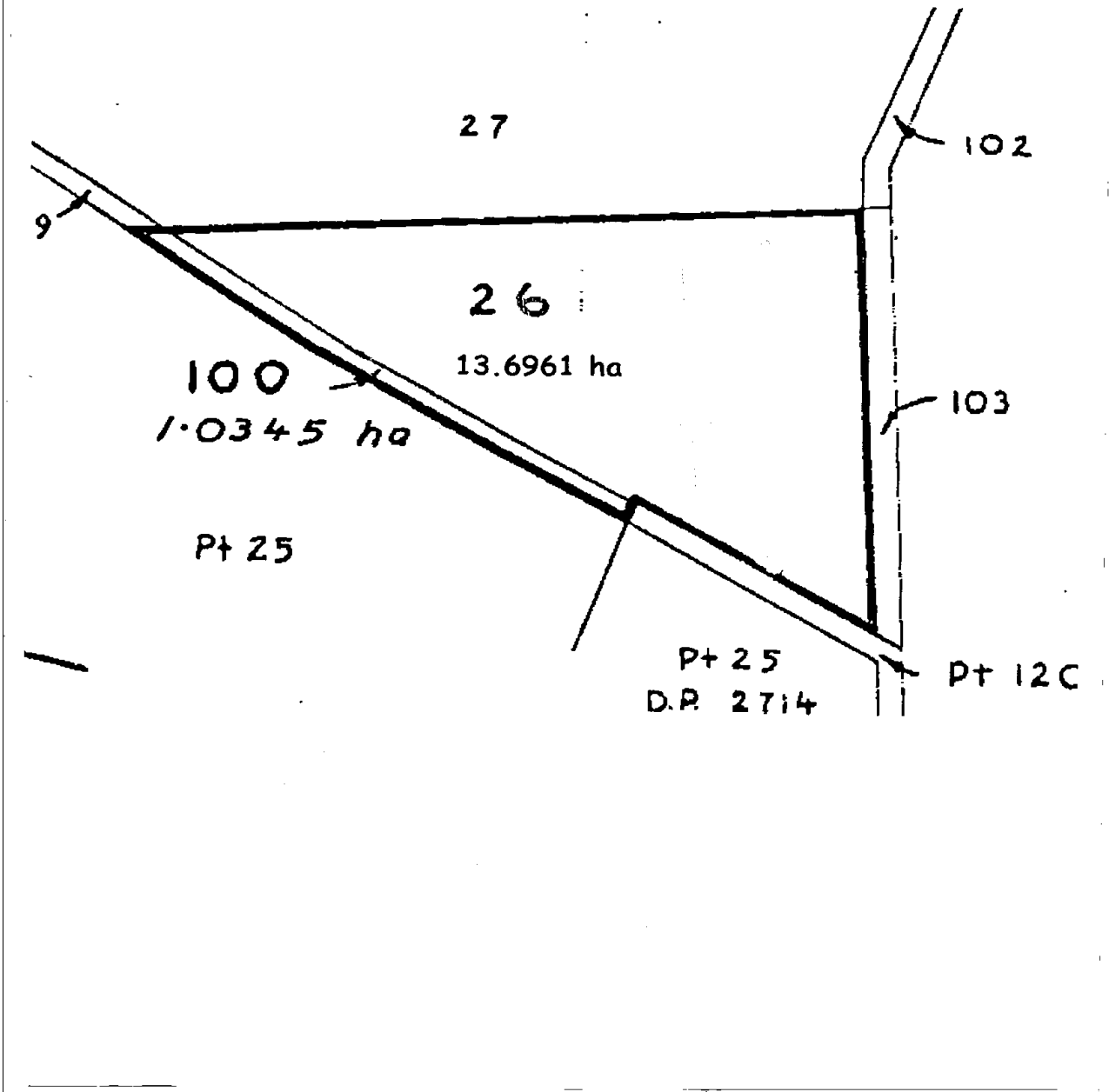



**RECORD OF TITLE
UNDER LAND TRANSFER ACT 2017
FREEHOLD**

**Guaranteed Search Copy issued under Section 60 of the Land
Transfer Act 2017**



R. W. Muir
Registrar-General
of Land

Identifier OT106/99
Land Registration District Otago
Date Issued 23 July 1895

Prior References

WA 3/8

Estate Fee Simple
Area 23.4718 hectares more or less
Legal Description Section 54 Block III Cromwell Survey
District

Registered Owners

New Zealand Cherry Corp (Leyser) Limited Partnership

Interests

The abovementioned land is subject to interests, easements and rights under the Land relating to mining, mines and minerals

11211780.3 Mortgage to Bank of New Zealand - 31.8.2018 at 4:12 pm

